

**This electronic collection of documents is provided
for the convenience of the user
and is Not a Certified Document –**

**The documents contained herein were originally issued
and sealed by the individuals whose names and license
numbers appear on each page, on the dates appearing
with their signature on that page.**

**This file or an individual page
shall not be considered a certified document.**

STATE OF NORTH CAROLINA
DIVISION OF HIGHWAYS

STATE	STATE PROJECT REFERENCE NO.	SHEET NO.	TOTAL SHEETS
N.C.	R-5792AC, AE & AH	1	11
STATE PROJ. NO.	F.A. PROJ. NO.	DESCRIPTION	
44922.1.8	TAP-1229(034)	PE	
44922.3.8	TAP-1229(029)	CONST. IREDELL > 5,000	
44922.3.12	TAP-1229(030)	CONST. IREDELL < 5,000	
44922.3.13	TAP-1229(031)	CONST. ALEX. < 5,000	

ALEXANDER & IREDELL COUNTIES

**LOCATION: VARIOUS THOUGHTOUT:
TAYLORSVILLE, HARMONY, AND STATESVILLE.**

TYPE OF WORK: UPGRADE EXISTING CURB RAMPS TO CURRENT STANDARDS.

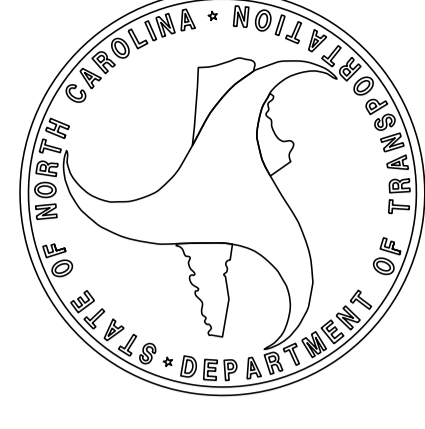
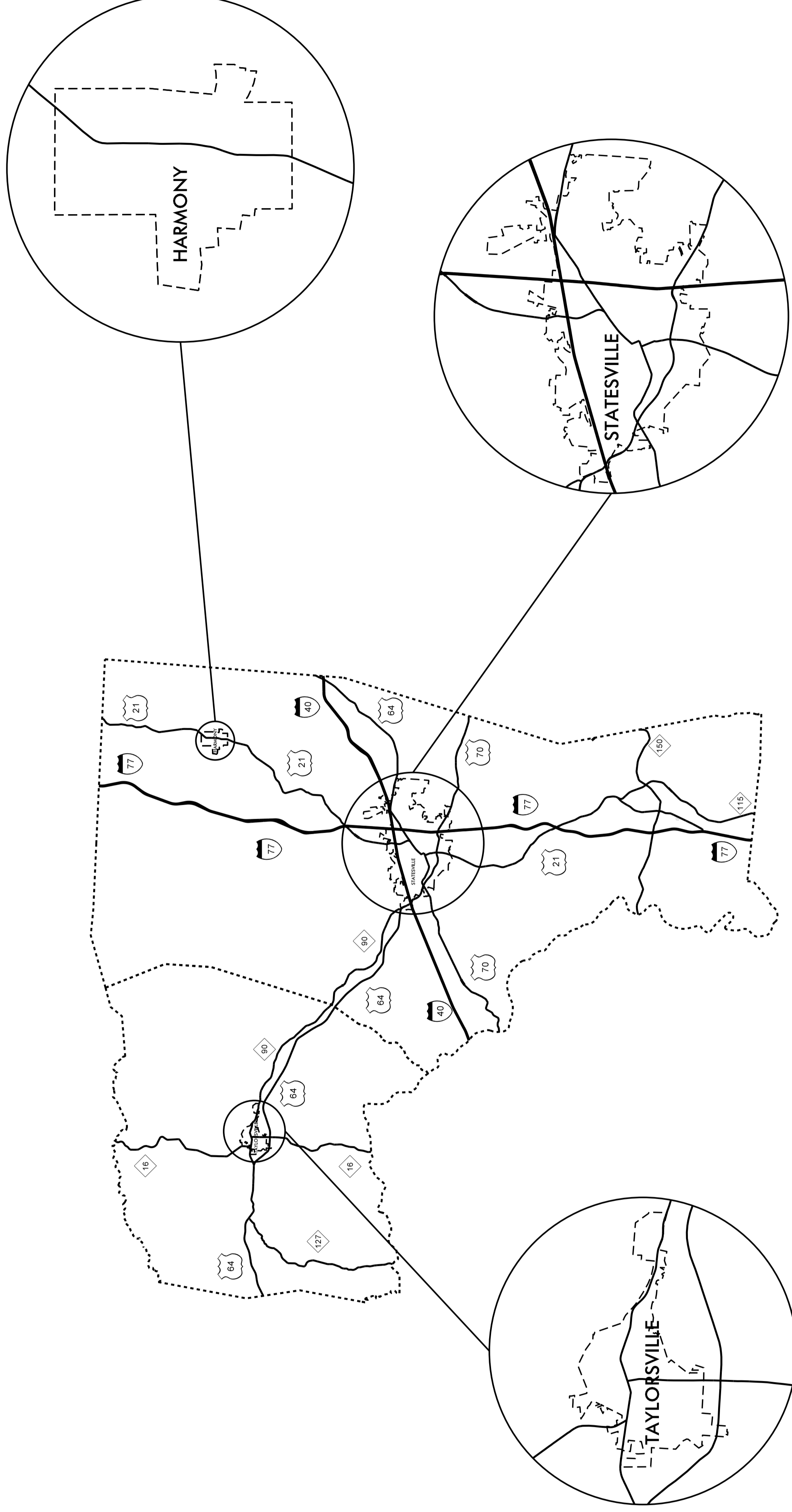

Prepared in the Office of: DIVISION OF HIGHWAYS 1710 E. Marion St., Shelby, NC 28150 <small>2018 STANDARD SPECIFICATIONS</small>	
RIGHT OF WAY DATE: N/A	JOHN COOK DISTRICT ENGINEER
LETTING DATE: OCT. 23, 2018	JOHNATHAN BARNETTE ENGINEERING TECH.

CONTRACT: DL00189 TTP PROJECT: R-5792AC, AE & AH

<p>SHEET NUMBER</p> <p>1</p> <p>1A</p> <p>1B</p> <p>2C-1 THRU 2C-3</p> <p>4 THRU 11</p> <p>TMP-1 THRU TMP-1B</p>	<p>INDEX OF SHEETS</p> <p>SHEET</p> <p>TITLE SHEET</p> <p>INDEX OF SHEETS, GENERAL NOTES, AND STANDARD DRAWINGS</p> <p>CONVENTIONAL SYMBOLS</p> <p>SPECIAL DETAILS</p> <p>PLAN AND SUMMARY OF QUANTITIES</p> <p>TRAFFIC MANAGEMENT PLANS</p>	<p>GENERAL NOTES:</p> <p>CURB RAMPS</p> <p>CURB RAMPS ARE SHOWN ON THE PLANS AT APPROXIMATE LOCATIONS. CONSTRUCT ALL CURB RAMPS ACCORDANCE WITH STD 848.05, 848.06, & SPECIAL DETAILS.</p>	<p>2018 SPECIFICATIONS</p>	<p>2018 ROADWAY ENGLISH STANDARD DRAWINGS</p> <p>The following Roadway Standards as appear in "Roadway Standard Drawings" Highway Design Branch - N. C. Department of Transportation - Raleigh, N. C., Dated January, 2012 are applicable to this project and by reference hereby are considered a part of these plans:</p> <table border="0"> <tr> <td>STD. NO.</td> <td>TITLE</td> </tr> <tr> <td>DIVISION 8 - INCIDENTALS</td> <td></td> </tr> <tr> <td>848.01</td> <td>Concrete Curb, Gutter and Curb & Gutter</td> </tr> <tr> <td>848.01</td> <td>Concrete Sidewalk</td> </tr> <tr> <td>848.05</td> <td>Curb Ramp - Proposed Curb & Gutter</td> </tr> <tr> <td>848.06</td> <td>Curb Ramp - Existing Curb & Gutter</td> </tr> </table>	STD. NO.	TITLE	DIVISION 8 - INCIDENTALS		848.01	Concrete Curb, Gutter and Curb & Gutter	848.01	Concrete Sidewalk	848.05	Curb Ramp - Proposed Curb & Gutter	848.06	Curb Ramp - Existing Curb & Gutter
STD. NO.	TITLE															
DIVISION 8 - INCIDENTALS																
848.01	Concrete Curb, Gutter and Curb & Gutter															
848.01	Concrete Sidewalk															
848.05	Curb Ramp - Proposed Curb & Gutter															
848.06	Curb Ramp - Existing Curb & Gutter															

STATE OF NORTH CAROLINA, DIVISION OF HIGHWAYS
CONVENTIONAL PLAN SHEET SYMBOLS

RAILROADS: Note: Not to Scale *S.U.E. = Subsurface Utility Engineering

- Standard Gauge
RR Signal Milepost
Switch
RR Abandoned
RR Dismantled

- Hedge
Woods Line
Orchard
Vineyard

EXISTING STRUCTURES:

- MAJOR: Bridge, Tunnel or Box Culvert
Bridge Wing Wall, Head Wall and End Wall
MINOR: Head and End Wall
Pipe Culvert
Footbridge
Drainage Box: Catch Basin, DI or JB
Paved Ditch Gutter
Storm Sewer Manhole
Storm Sewer

RIGHT OF WAY & PROJECT CONTROL:

- Secondary Horiz and Vert Control Point
Primary Horiz Control Point
Primary Horiz and Vert Control Point
Exist Permanent Easment Pin and Cap
New Permanent Easment Pin and Cap
Vertical Benchmark
Existing Right of Way Marker
Existing Right of Way Line
New Right of Way Line
New Right of Way Line with Pin and Cap
New Right of Way Line with Concrete or Granite RW Marker
New Control of Access Line with Concrete CA Marker
Existing Control of Access
New Control of Access
Existing Easement Line
New Temporary Construction Easement
New Temporary Drainage Easement
New Permanent Drainage Easement
New Permanent Drainage / Utility Easement
New Permanent Utility Easement
New Temporary Utility Easement
New Aerial Utility Easement

BOUNDARIES AND PROPERTY:

- State Line
County Line
Township Line
City Line
Reservation Line
Property Line
Existing Iron Pin
Computed Property Corner
Property Monument
Parcel/Sequence Number
Existing Fence Line
Proposed Woven Wire Fence
Proposed Chain Link Fence
Proposed Barbed Wire Fence
Existing Wetland Boundary
Proposed Wetland Boundary
Existing Endangered Animal Boundary
Existing Endangered Plant Boundary
Existing Historic Property Boundary
Known Contamination Area: Soil
Potential Contamination Area: Soil
Known Contamination Area: Water
Potential Contamination Area: Water
Contaminated Site: Known or Potential

BUILDINGS AND OTHER CULTURE:

- Gas Pump Vent or U/G Tank Cap
Sign
Well
Small Mine
Foundation
Area Outline
Cemetery
Building
School
Church
Dam

HYDROLOGY:

- Stream or Body of Water
Hydro, Pool or Reservoir
Jurisdictional Stream
Buffer Zone 1
Buffer Zone 2
Flow Arrow
Disappearing Stream
Spring
Wetland
Proposed Lateral, Tail, Head Ditch
False Sump

WATER:

- Water Manhole
Water Meter
Water Valve
Water Hydrant
UG Water Line LOS B (S.U.E.*)
UG Water Line LOS C (S.U.E.*)
UG Water Line LOS D (S.U.E.*)
Above Ground Water Line

- TV: TV Pedestal
TV Tower
UG TV Cable Hand Hole
UG TV Cable LOS B (S.U.E.*)
UG TV Cable LOS C (S.U.E.*)
UG TV Cable LOS D (S.U.E.*)
UG Fiber Optic Cable LOS B (S.U.E.*)
UG Fiber Optic Cable LOS C (S.U.E.*)
UG Fiber Optic Cable LOS D (S.U.E.*)

GAS:

- Gas Valve
Gas Meter
UG Gas Line LOS B (S.U.E.*)
UG Gas Line LOS C (S.U.E.*)
UG Gas Line LOS D (S.U.E.*)
Above Ground Gas Line

SANITARY SEWER:

- Sanitary Sewer Manhole
Sanitary Sewer Cleanout
UG Sanitary Sewer Line
Above Ground Sanitary Sewer
SS Forced Main Line LOS B (S.U.E.*)
SS Forced Main Line LOS C (S.U.E.*)
SS Forced Main Line LOS D (S.U.E.*)

MISCELLANEOUS:

- Utility Pole
Utility Pole with Base
Utility Located Object
Utility Traffic Signal Box
Utility Unknown U/G Line LOS B (S.U.E.*)
UG Tank; Water, Gas, Oil
Underground Storage Tank, Approx. Loc.
AG Tank; Water, Gas, Oil
Geoenvironmental Boring
UG Test Hole LOS A (S.U.E.*)
Abandoned According to Utility Records
End of Information
E.O.I.

ROADS AND RELATED FEATURES:

- Existing Edge of Pavement
Existing Curb
Proposed Slope Stakes Cut
Proposed Slope Stakes Fill
Proposed Curb Ramp
Existing Metal Guardrail
Proposed Guardrail
Existing Cable Guiderail
Proposed Cable Guiderail
Equality Symbol
Pavement Removal
VEGETATION:
Single Tree
Single Shrub

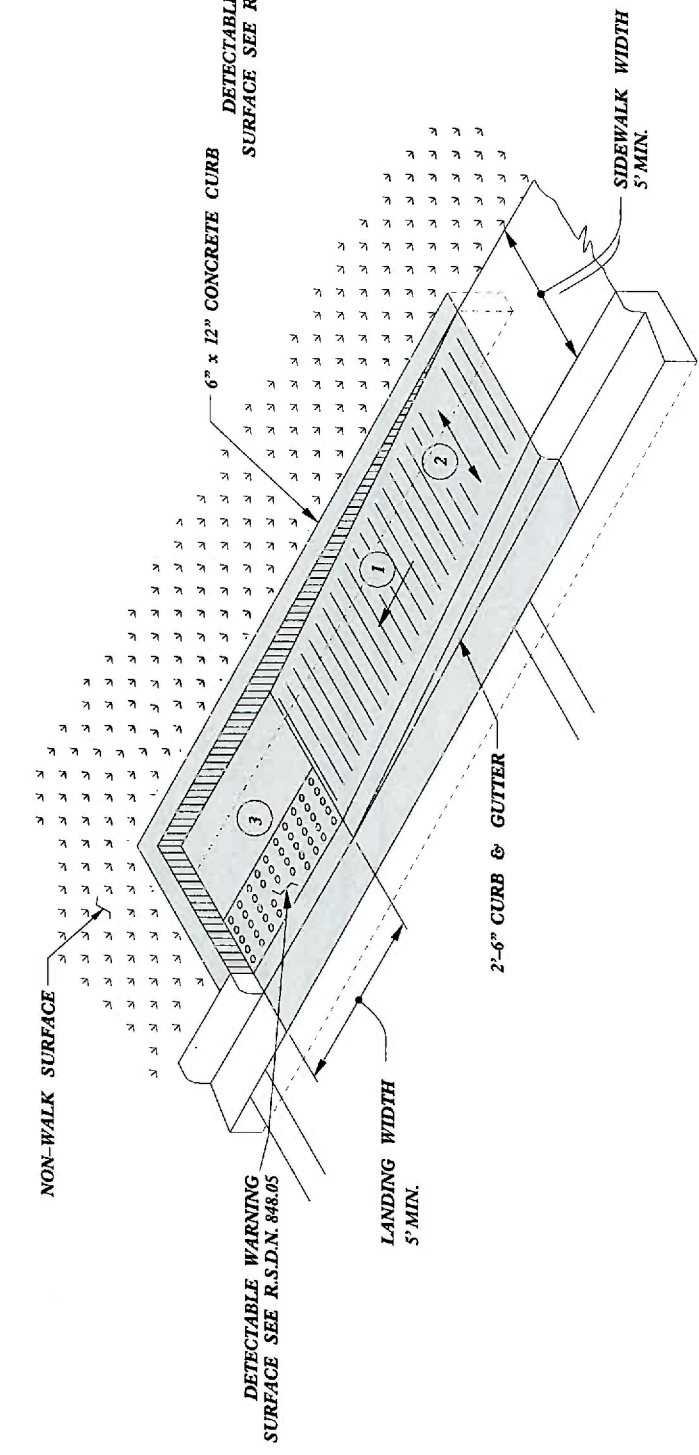

TYPE 1A

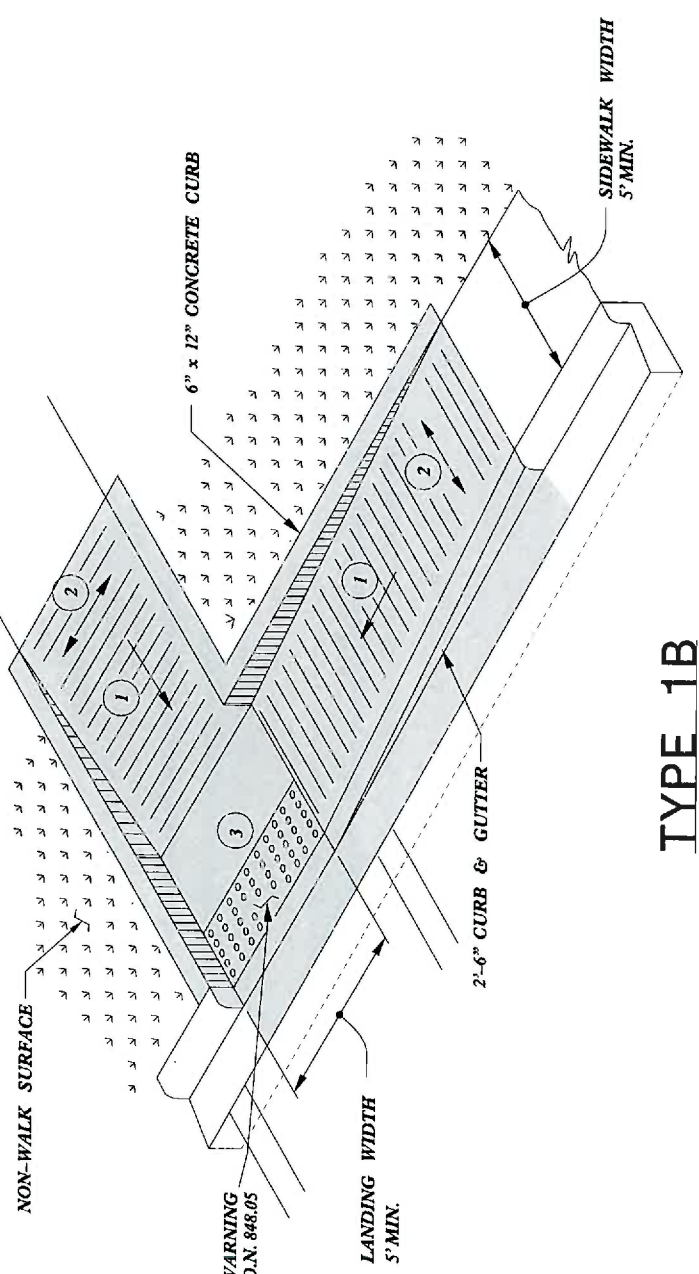

TYPE 1B

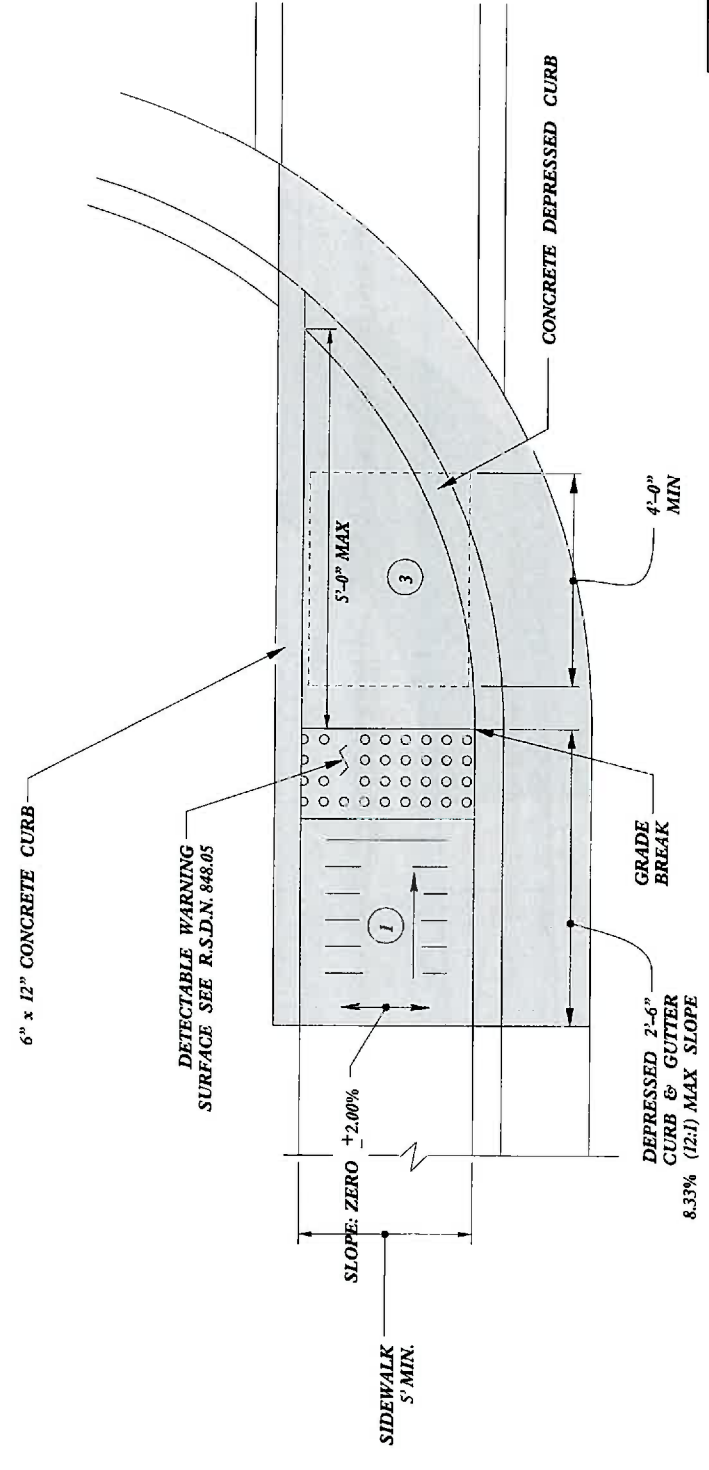

TYPE 1

PAY LIMITS FOR 1 CURB RAMP

- 1 8.33% (12:1) MAX RAMP SLOPE
- 2 CROSS SLOPE: 2.00%
- 3 CURB RAMP REQUIRE A (4'-0") MINIMUM LANDING WITH A MAXIMUM CROSS SLOPE AND LONGITUDINAL SLOPE OF 2.00% WHERE PEDESTRIANS PERFORM TURNING MANEUVERS. SLOPE TO DRAIN TO CURB.

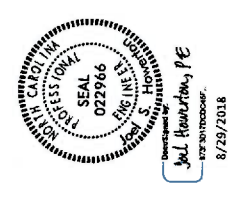

DOCUMENT NOT CONSIDERED FINAL UNLESS ALL REVISIONS COMPLETED

CONTRACT STANDARDS AND DEVELOPMENT UNIT
Office 919-707-6950 FAX 919-250-4119

CURB RAMPS
Directional Ramps

ORIGINAL BY: J.S. HOWERTON DATE: 7/7/11
 MODIFIED BY: DATE:
 CHECKED BY: DATE:
 FILE SPEC: 53ds/2012CurbRamp/CurbRampDetails.dwg

REFER TO ROADWAY STANDARD DRAWING NUMBER 848.05 SHEET 3 OF 3 FOR ALL RAMP NOTES

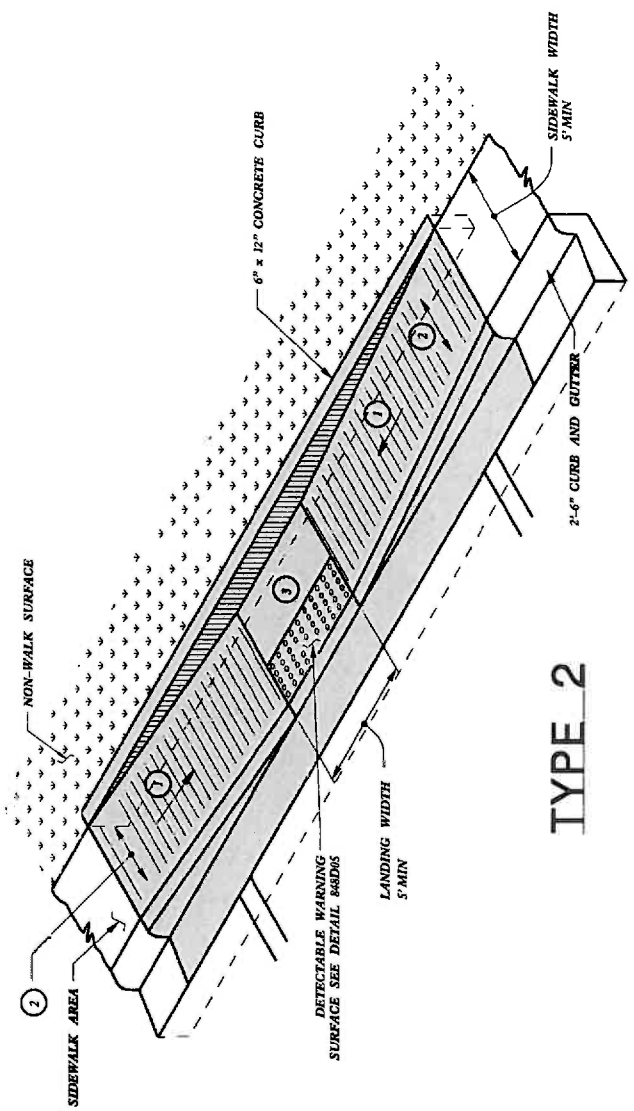

TYPE 2

PAY LIMITS FOR CURB RAMP



- 1 8.33% (12:1) MAX RAMP SLOPE
- 2 CROSS SLOPE: 2.00%
- 3 CURB RAMPS REQUIRE A (4'-0") MINIMUM LANDING WITH A MAXIMUM CROSS SLOPE AND LONGITUDINAL SLOPE OF 2.00% WHERE PEDESTRIANS PERFORM TURNING MANEUVERS. SLOPE TO DRAIN TO CURB.

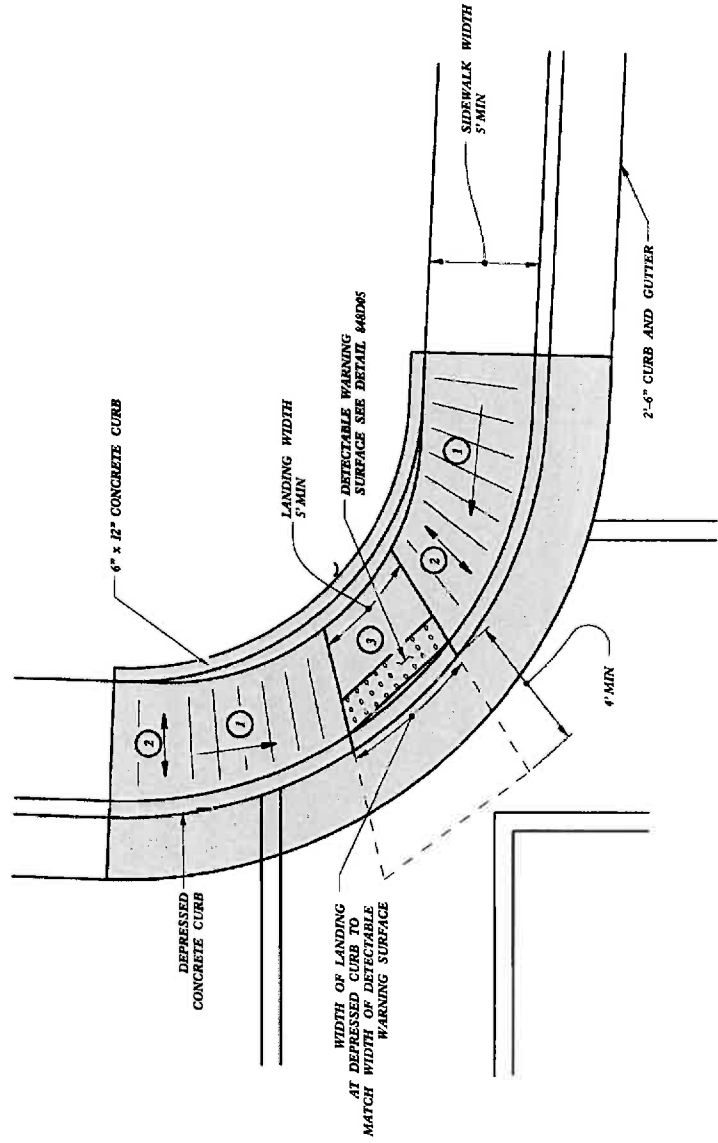

TYPE 2A

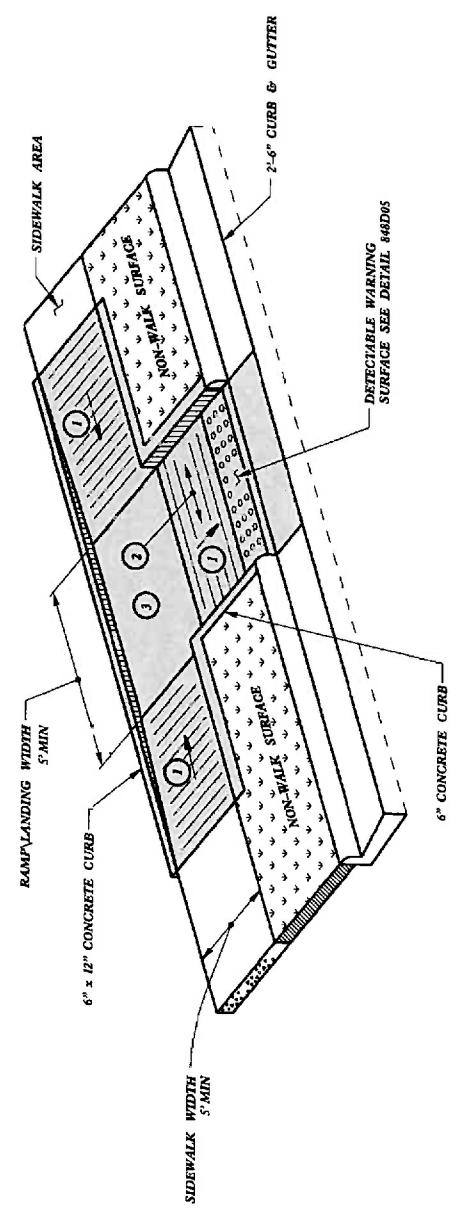

TYPE 2B

CONTRACT STANDARDS AND DEVELOPMENT UNIT
 Office 919-707-6950 FAX 919-250-4119

CURB RAMPS
 Parallel Ramps

ORIGINAL BY: J.S. HOWERTON DATE: 7/17/11
 MODIFIED BY: DATE:
 CHECKED BY: DATE:
 FILE SPEC: S:\65\2012\CurbRamp\CurbRampDetails.dwg

REFER TO ROADWAY STANDARD DRAWING NUMBER 848.05 SHEET 3 OF 3 FOR ALL RAMP NOTES

PAY LIMITS FOR CURB RAMP

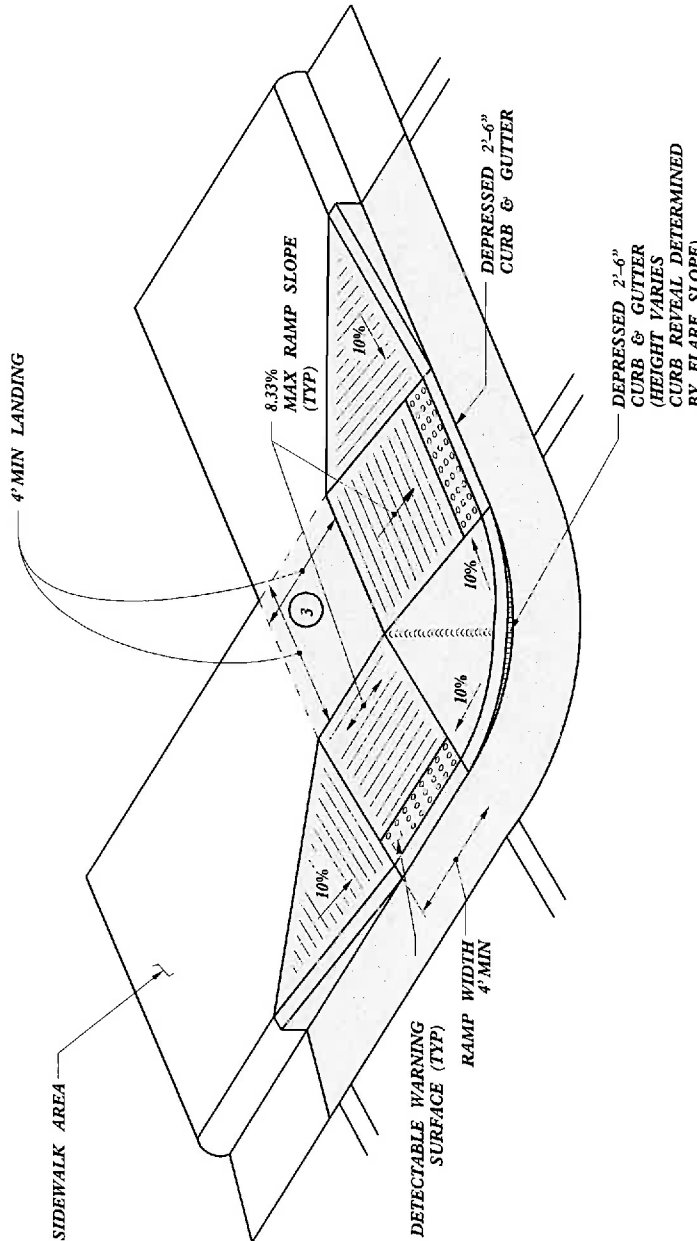

TYPE 4

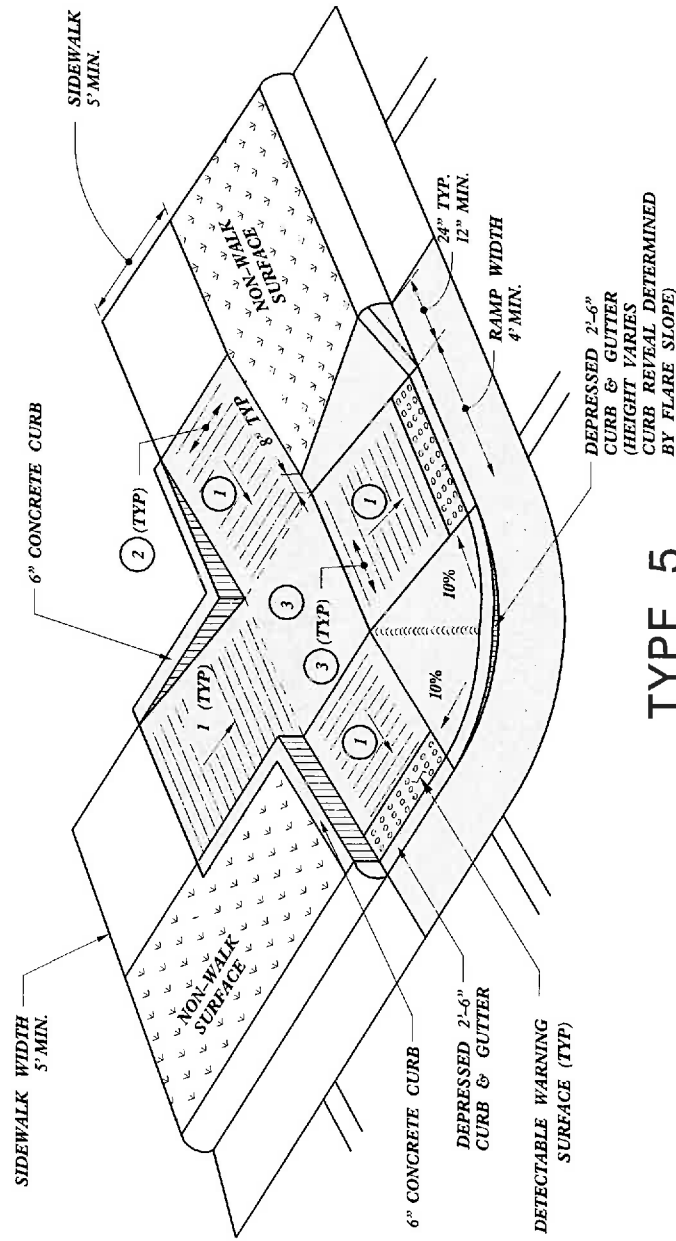

TYPE 5

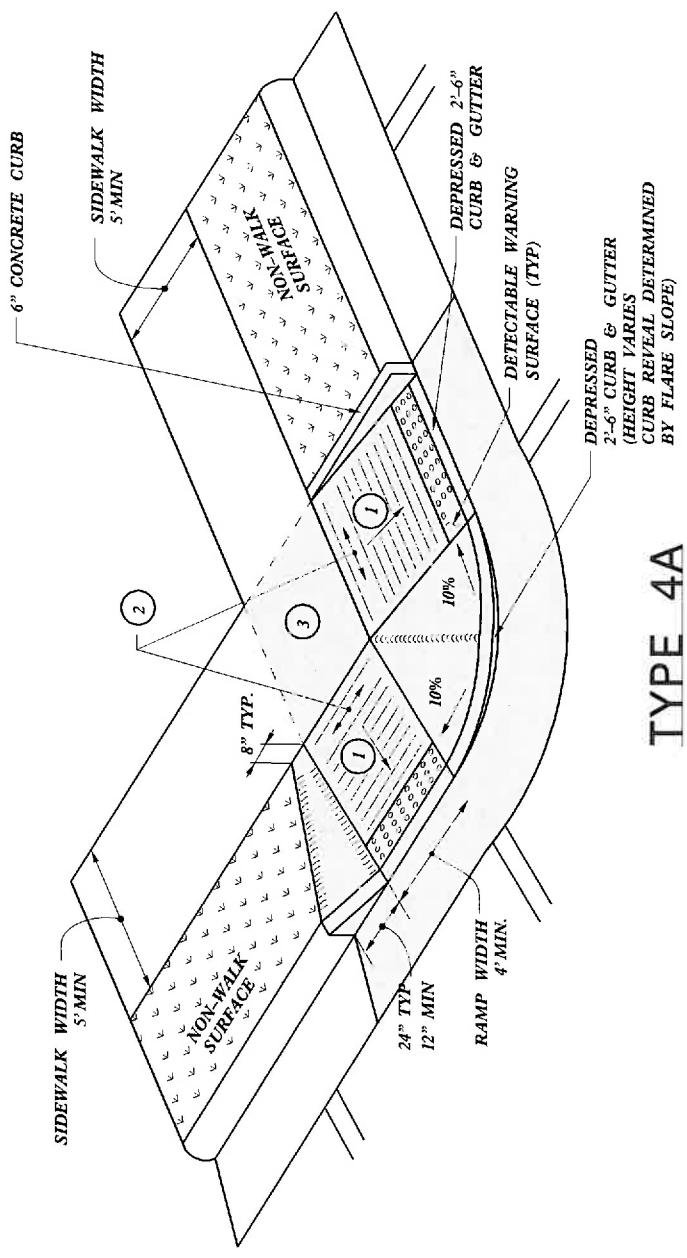

TYPE 4A

- 1 8.33% (12:1) MAX RAMP SLOPE
- 2 CROSS SLOPE: 2.00%
- 3 CURB RAMP REQUIRE A (4'-0") MINIMUM LANDING WITH A MAXIMUM CROSS SLOPE AND LONGITUDINAL SLOPE OF 2.00% WHERE PEDESTRIANS PERFORM TURNING MANEUVERS. SLOPE TO DRAIN TO CURB.

CONTRACT STANDARDS AND DEVELOPMENT UNIT
 Office 919-707-6950 FAX 919-250-4119
CURB RAMPS
 Shared Landing

ORIGINAL BY: J.S. HOWERTON DATE: 7/7/11
 MODIFIED BY: DATE:
 CHECKED BY: DATE:
 FILE SPEC: 2012CurbRampDetail.dwg

REFER TO ROADWAY STANDARD DRAWING NUMBER 848.05 SHEET 3 OF 3 FOR ALL RAMP NOTES

2012-MAR-2012 15:08
 C:\Users\jshover\Documents\Standard Drawings\2012 Standard Drawings\2012 Curb Ramp Special Details\Curb Ramp Details.dwg
 5/17/15

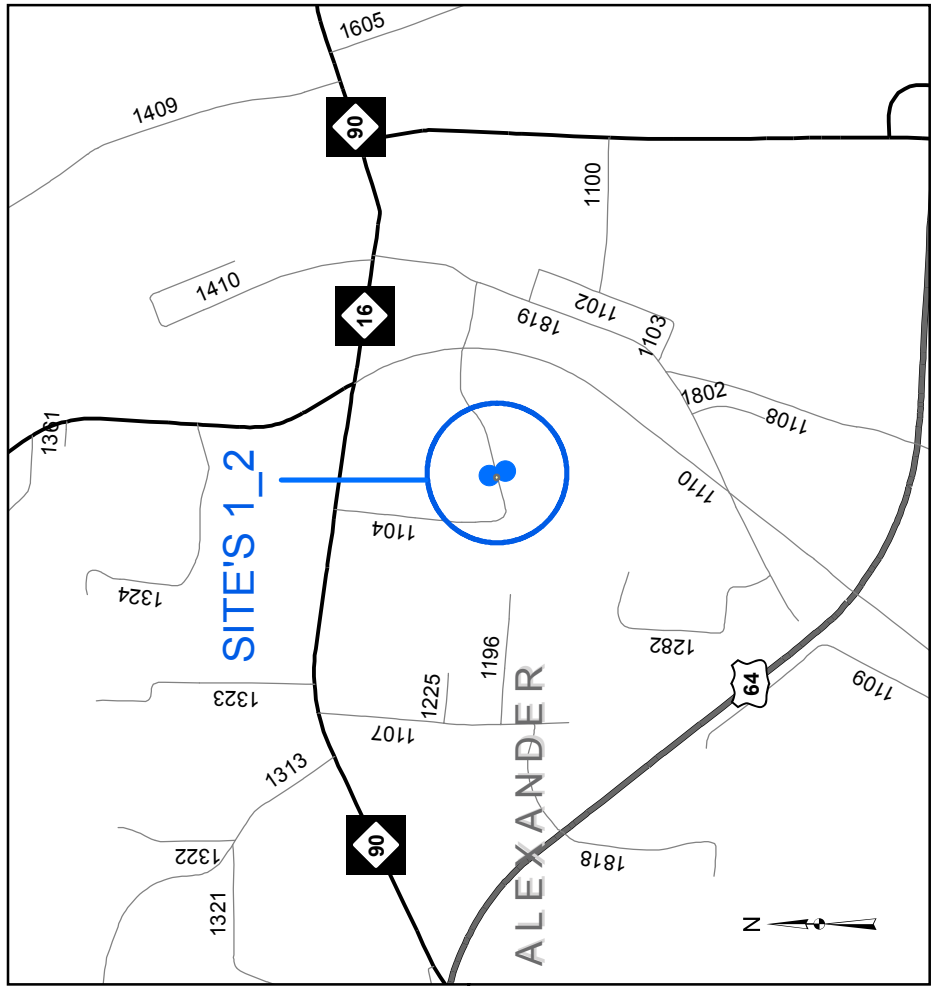
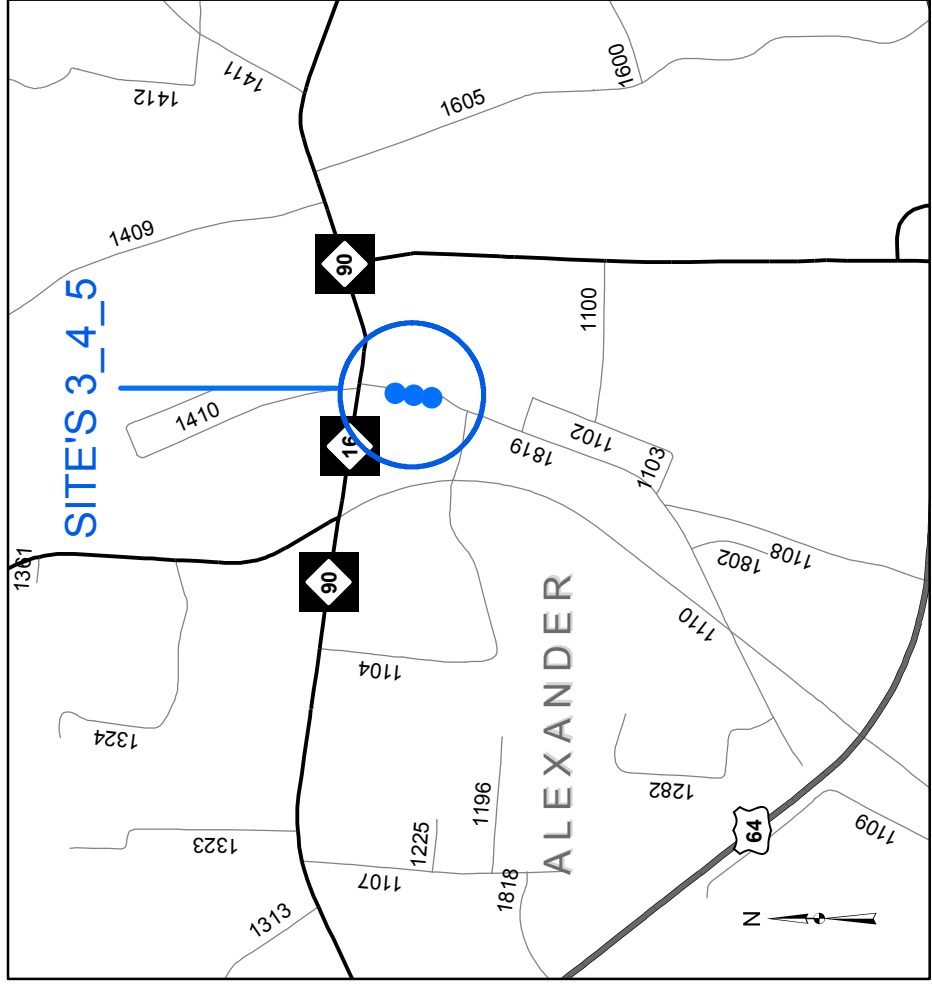
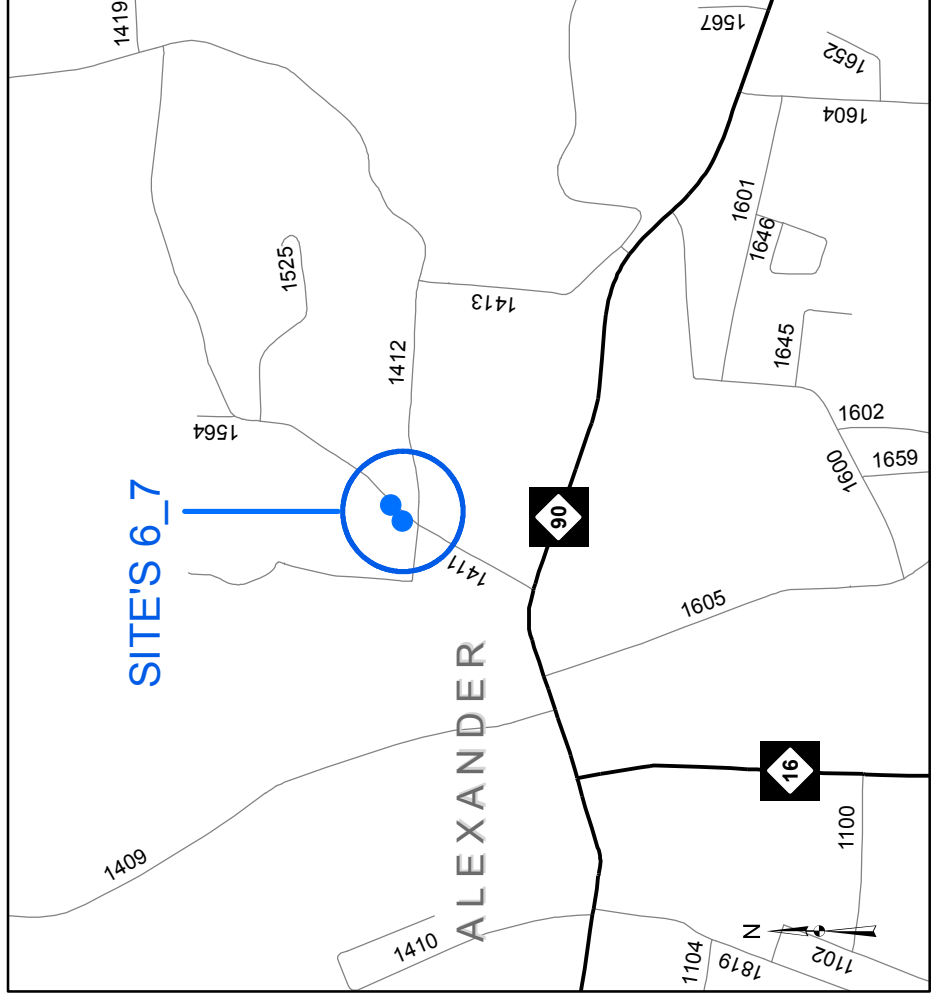

SR 1411 (LINNEYS MOUNTAIN RD.) @ 5th AVE. NE

SR 1819 (7th STREET) (TAYLORSVILLE ELEMENTARY SCHOOL)

SR 1104 (223 SCHOOL DRIVE) (ALEXANDER CENTRAL HIGH SCHOOL)

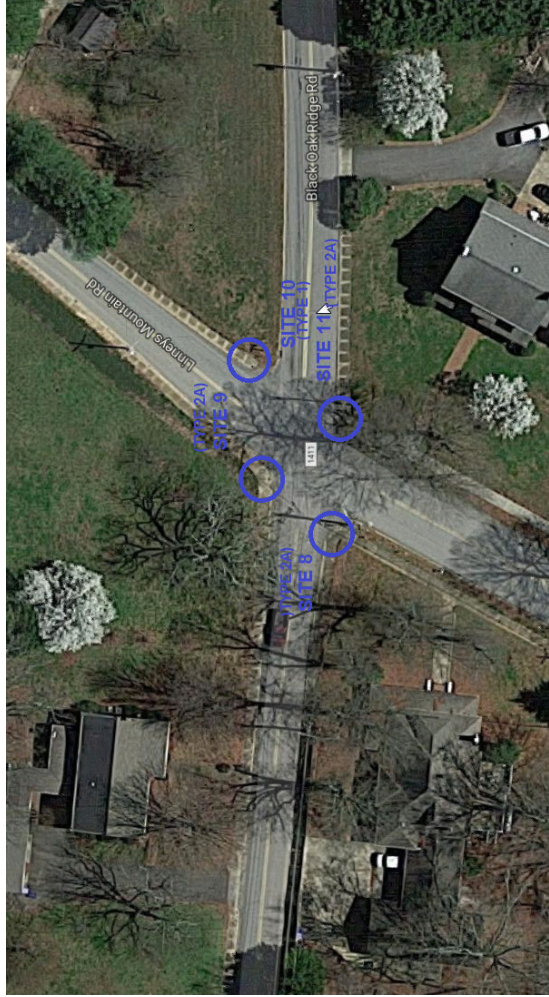
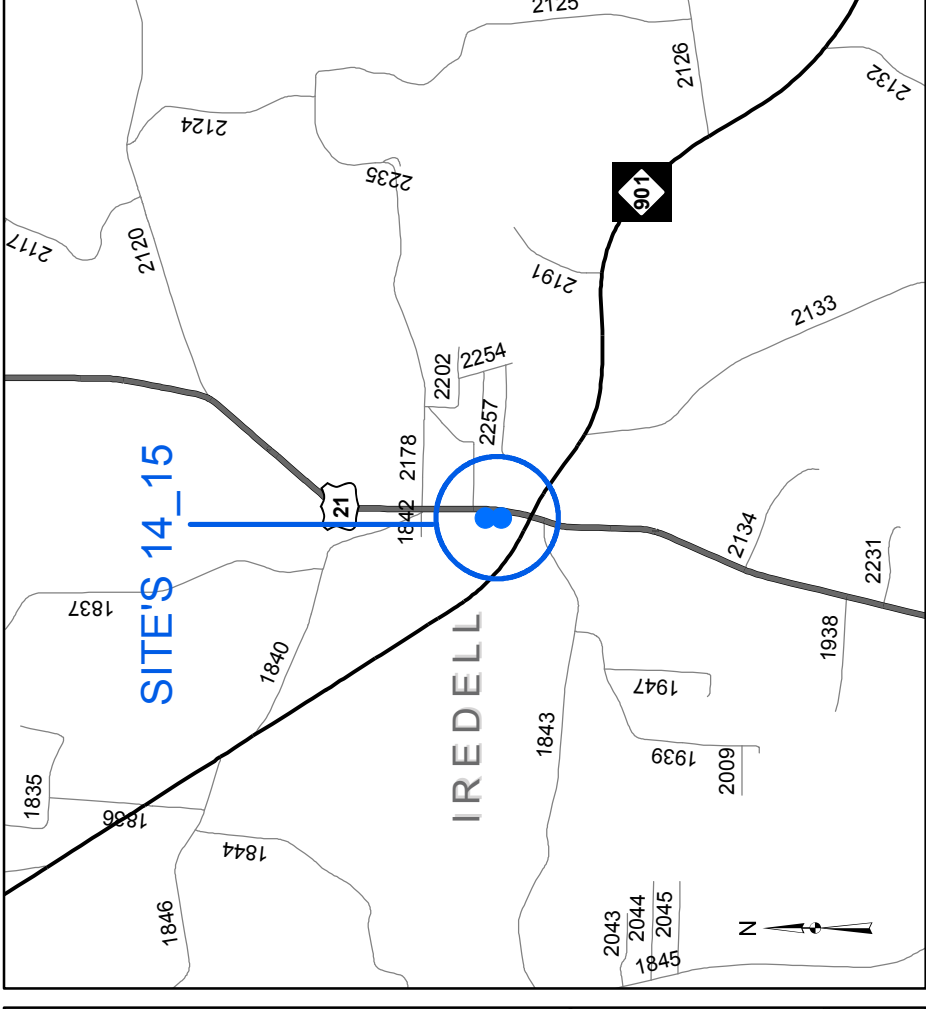
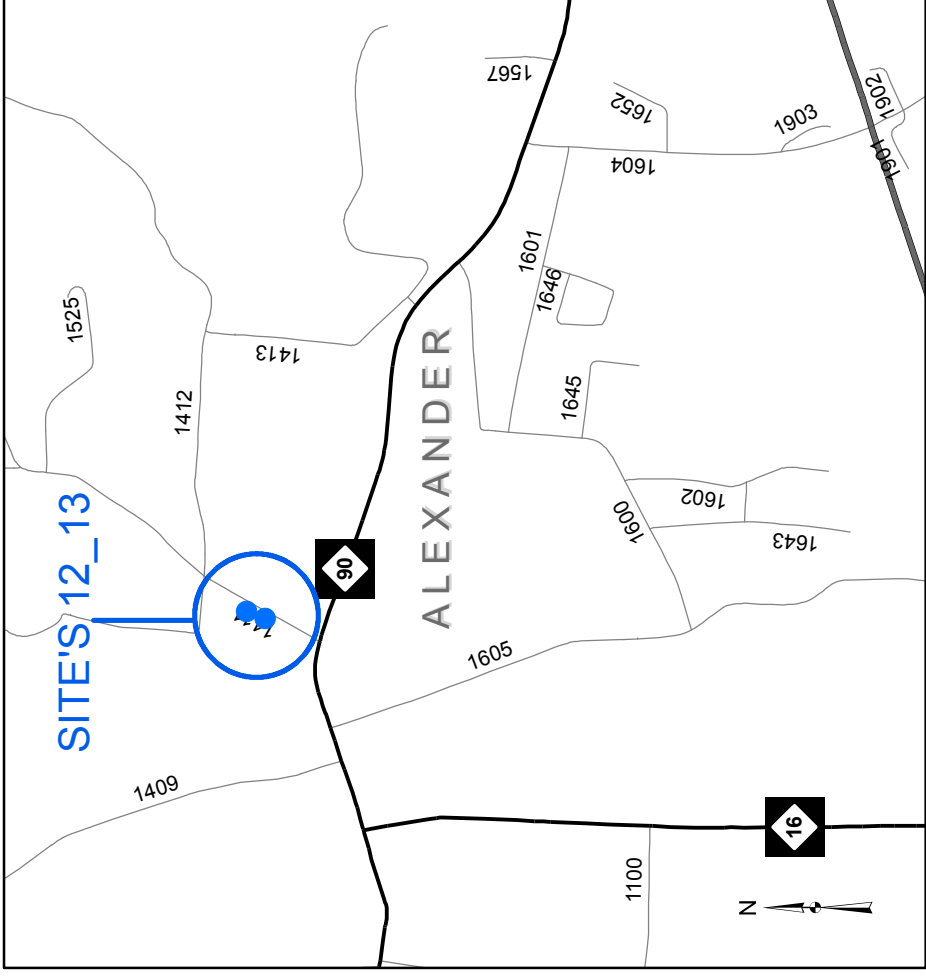
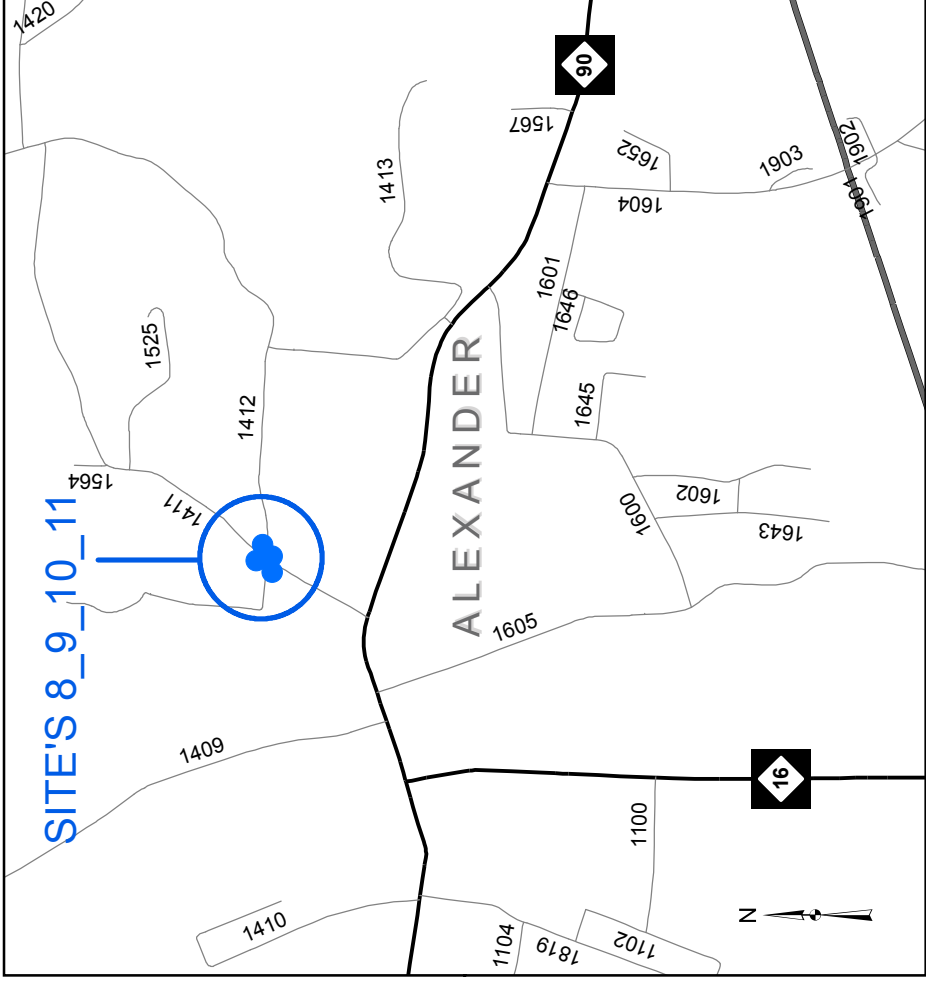

SR 1411 (LINNEYS MOUNTAIN RD.) @ SR 1412 (BLACK OAK RIDGE RD.)



SR 1411 (LINNEYS MOUNTAIN RD.) @ 2nd AVE. NE



US 21 @ 3349 HARMONY HIGHWAY (DOLLAR GENERAL)

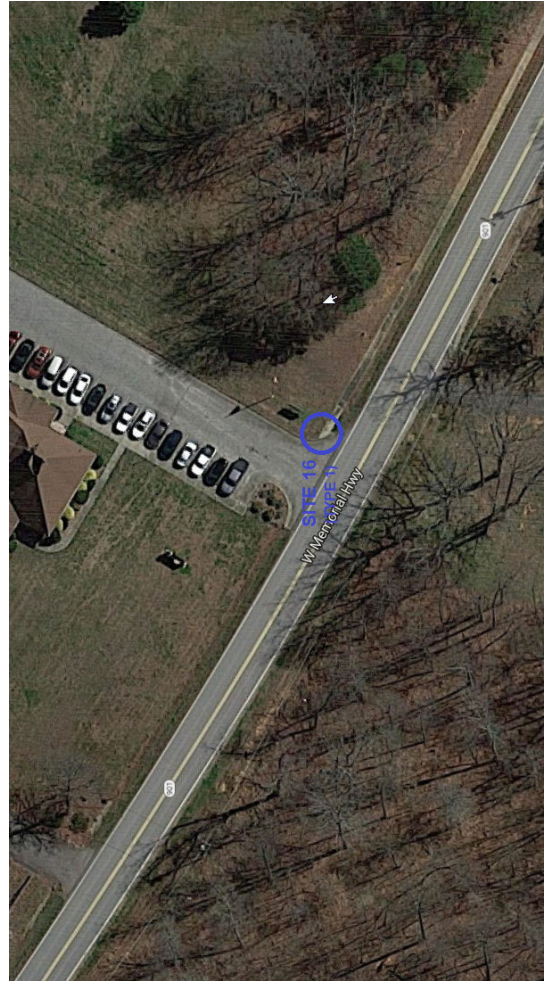
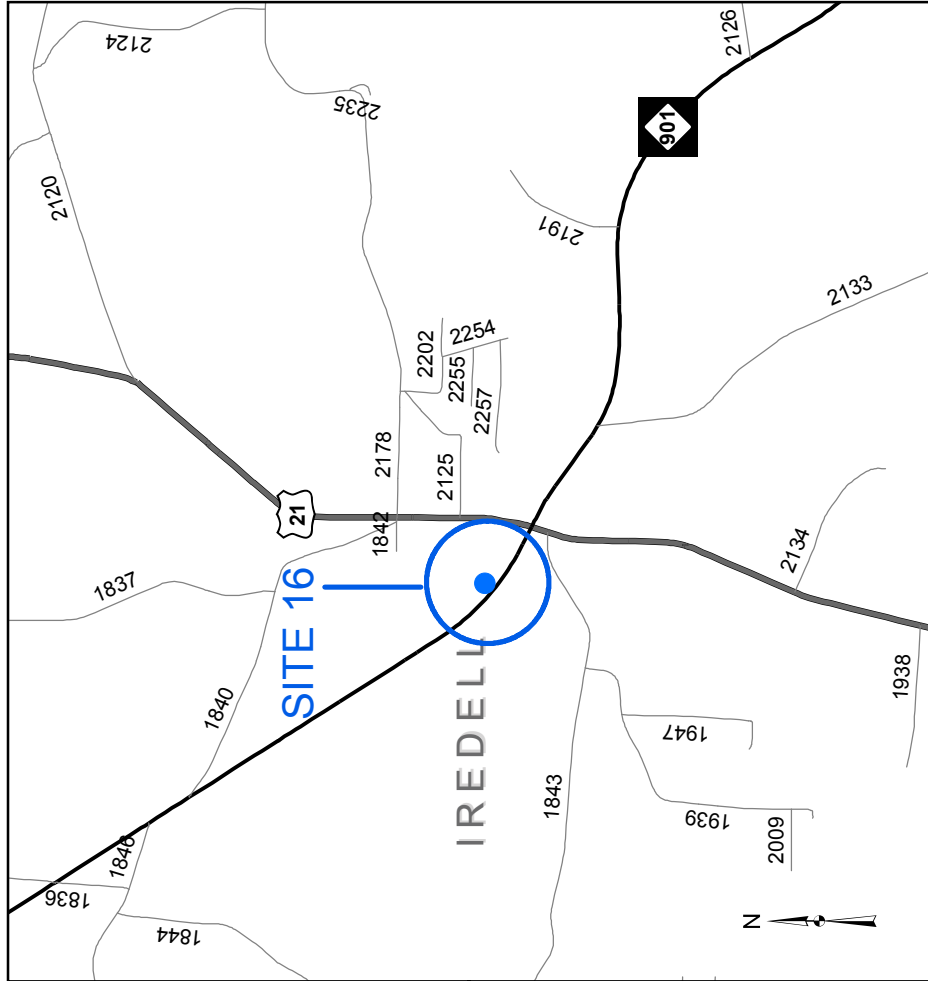
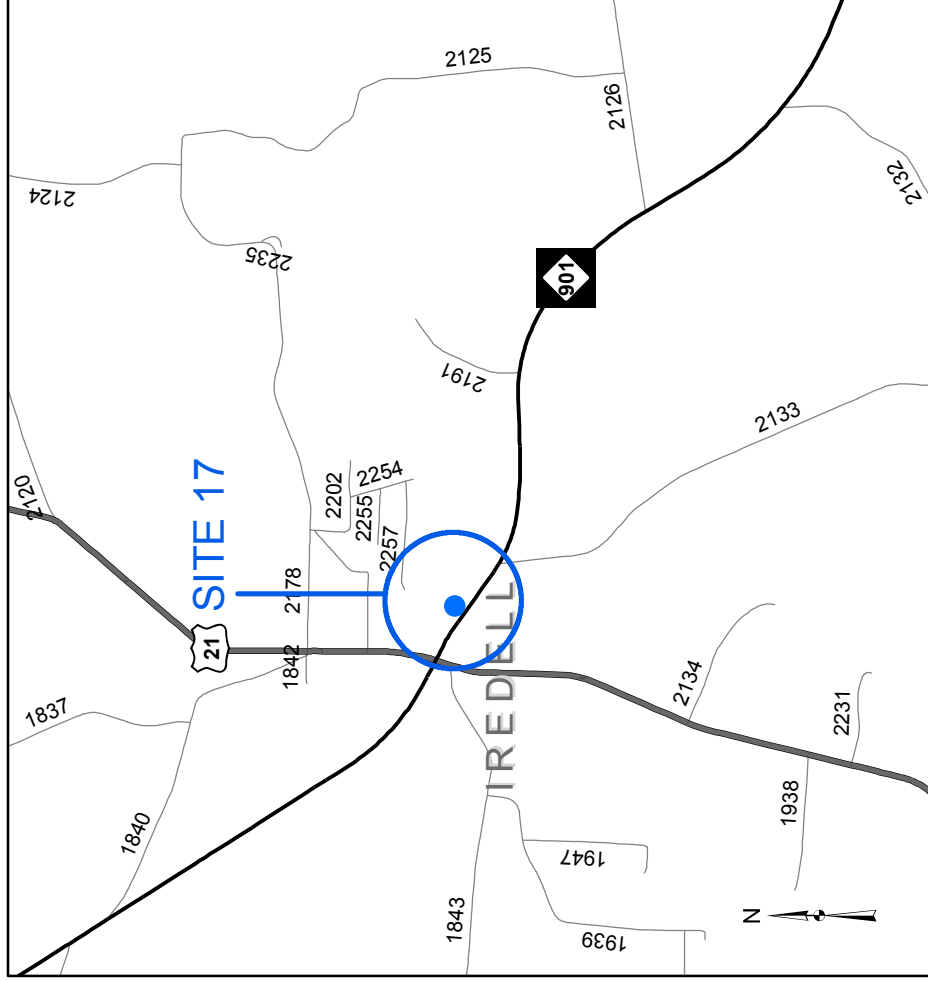
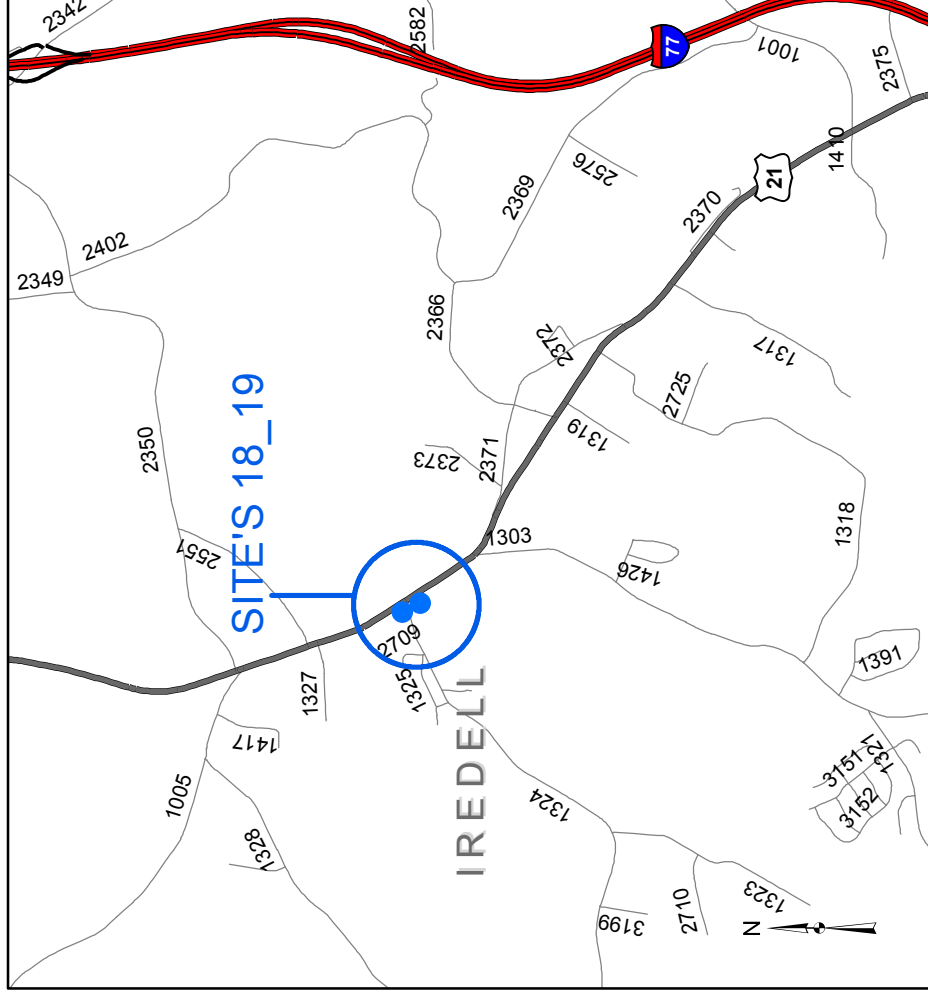

US 21 (N. MAIN STR.) @ SR 1324 (TALLEY STR.)

E. NC 901 (E. MEMORIAL HWY.) @ ISA'S LUM STR. (1000' EAST OF US 21)

NC 901 @ 136 HARMONY HWY. (HARMONY UNITED METHODIST CHURCH)

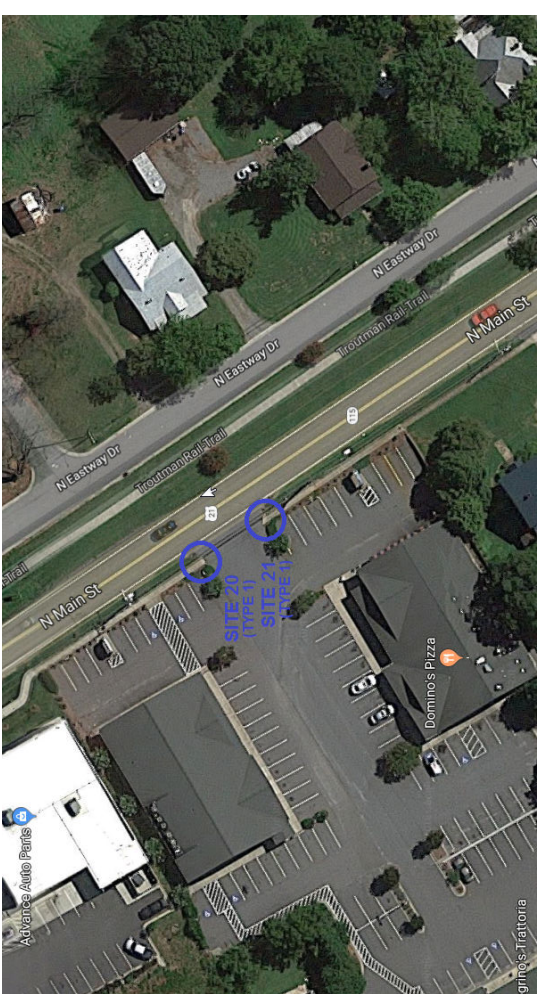
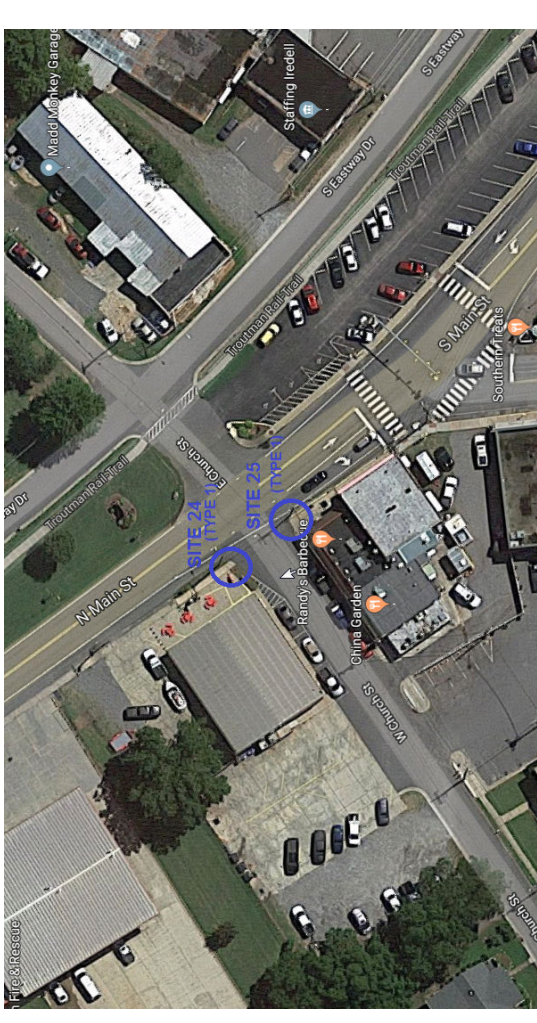
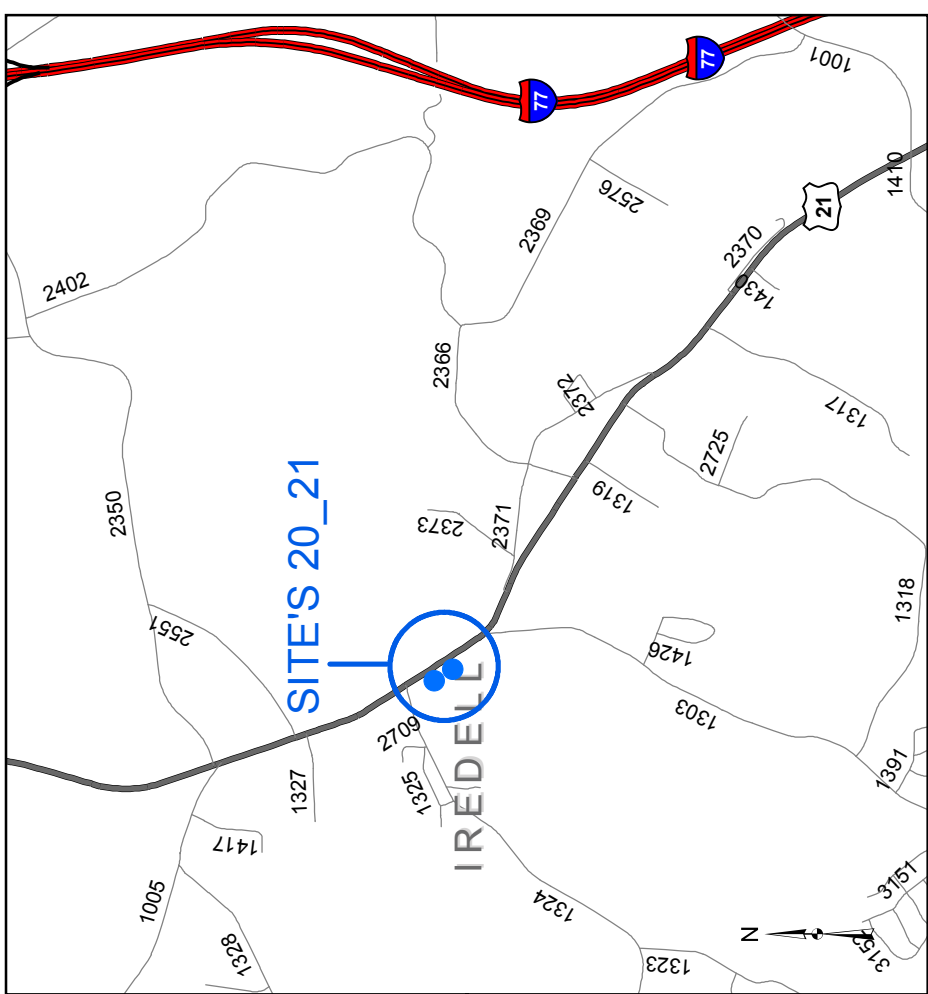
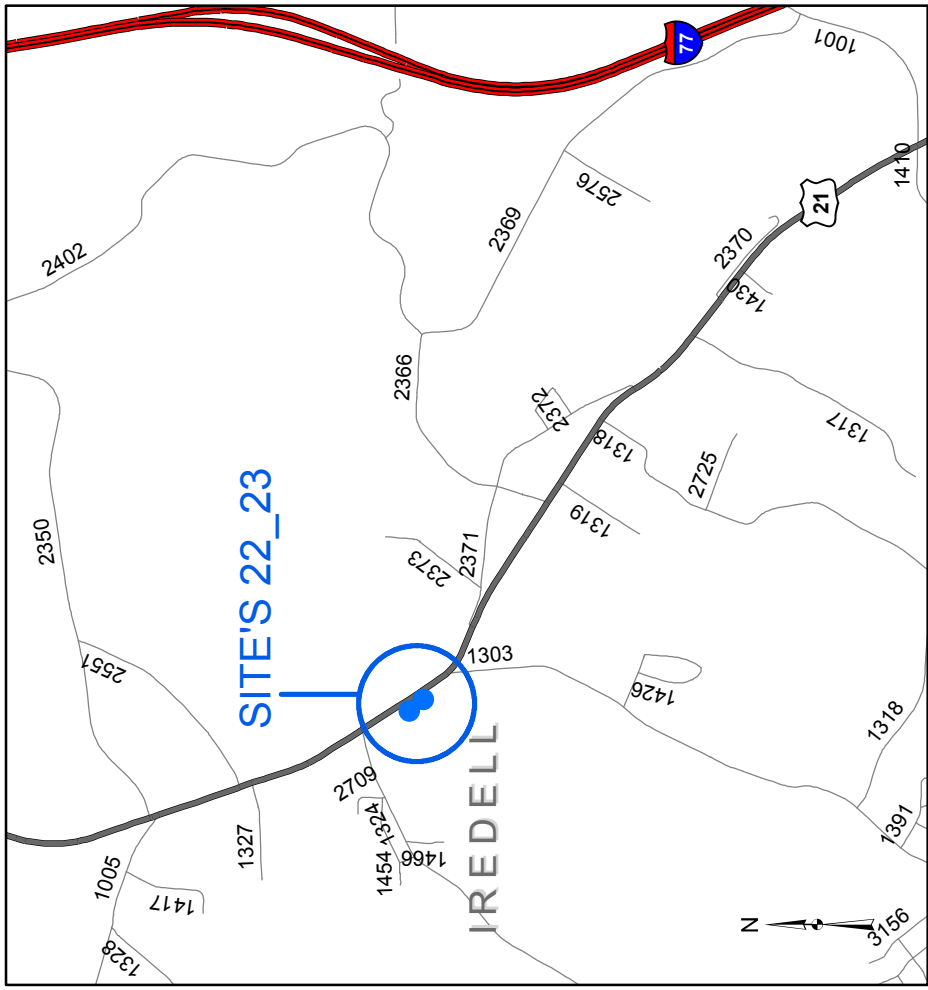
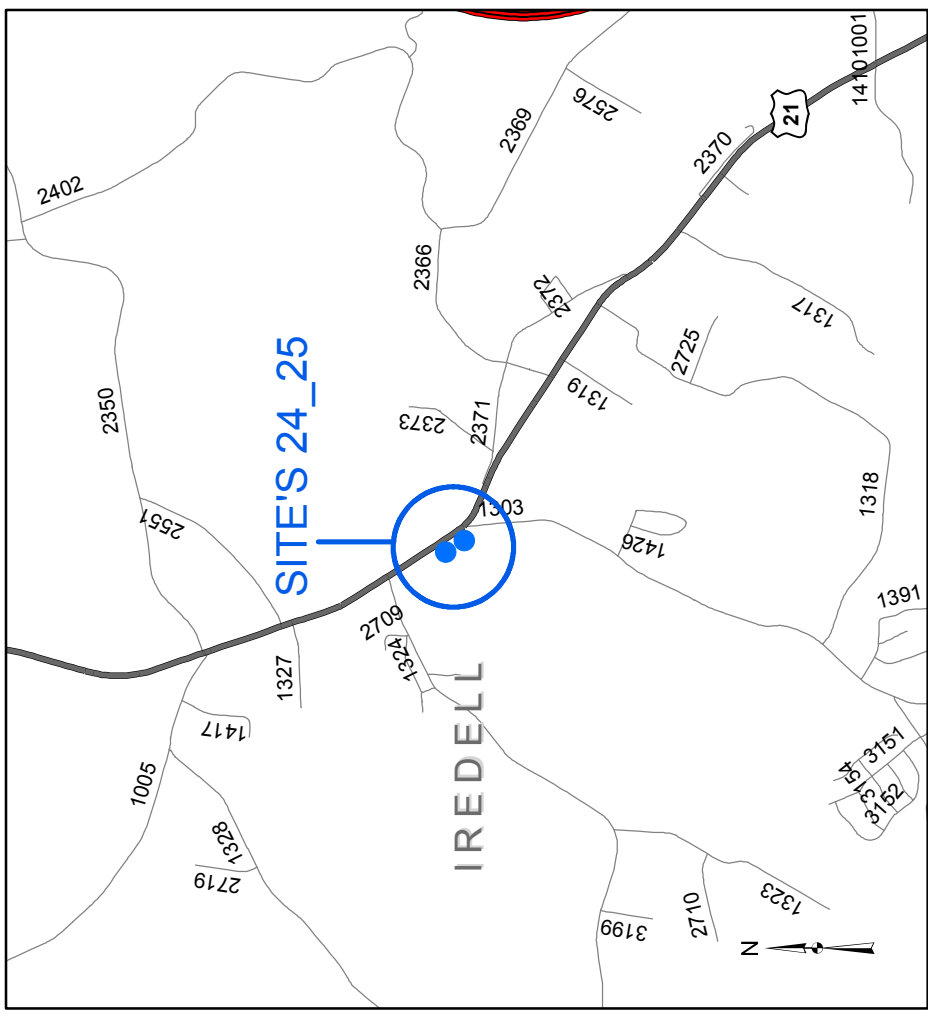

US 21 (N. MAIN STR.) @ W. CHURCH STR.

US 21 (N. MAIN STR.) @ MILLS AVE.

US 21 (N. MAIN STR.) @ 265 N. MAIN STR. (DOMINO'S PIZZA)

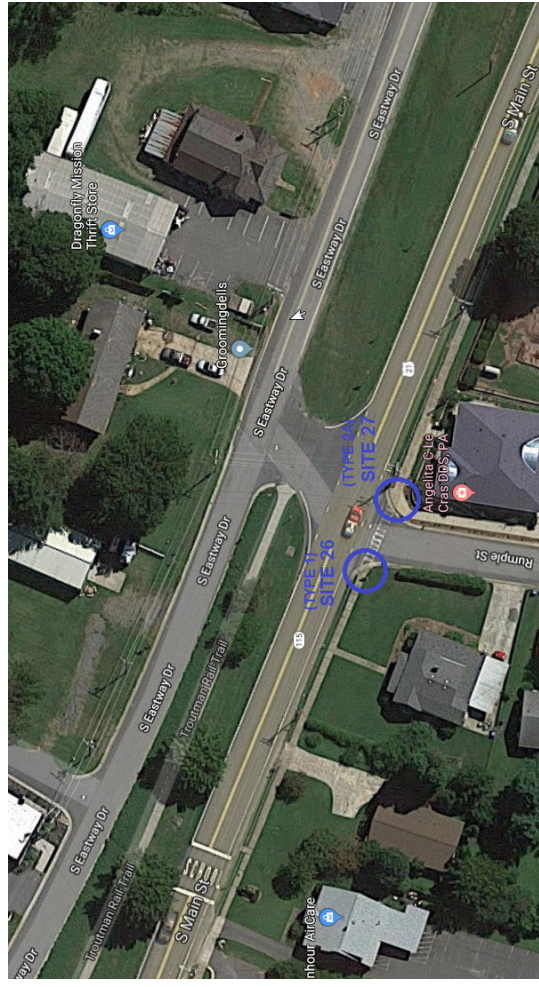
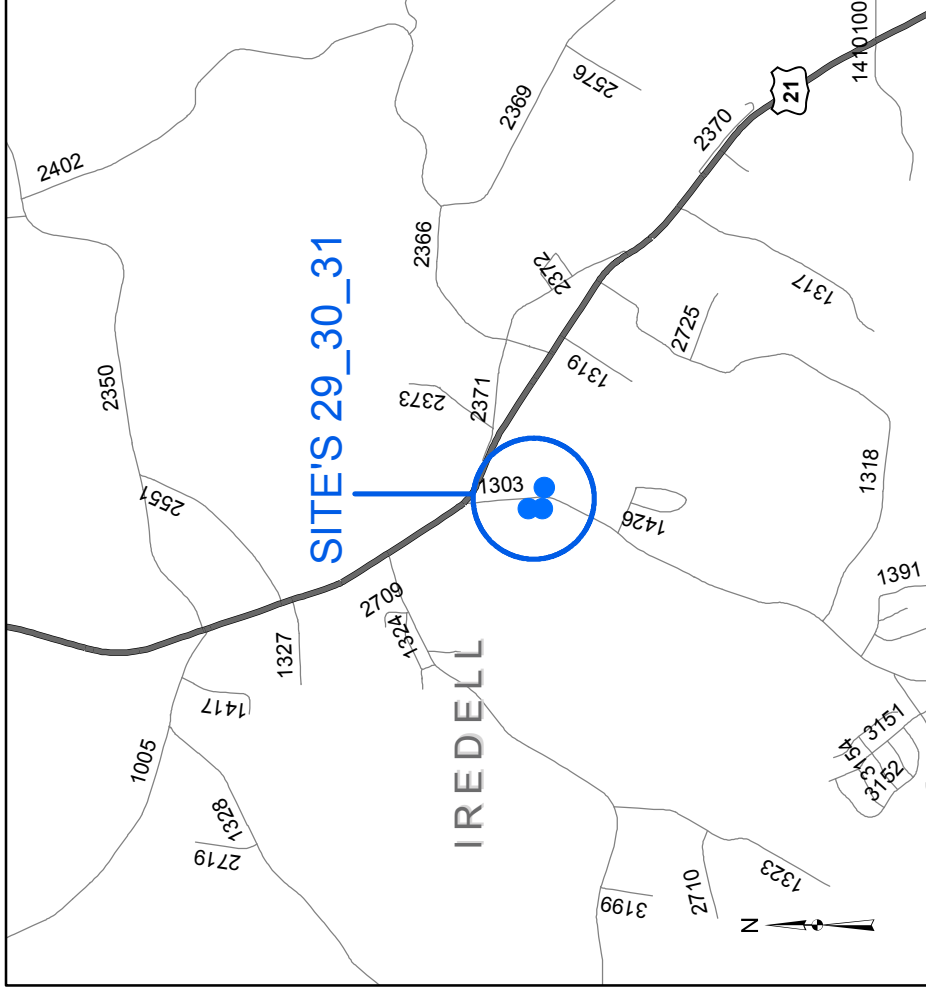
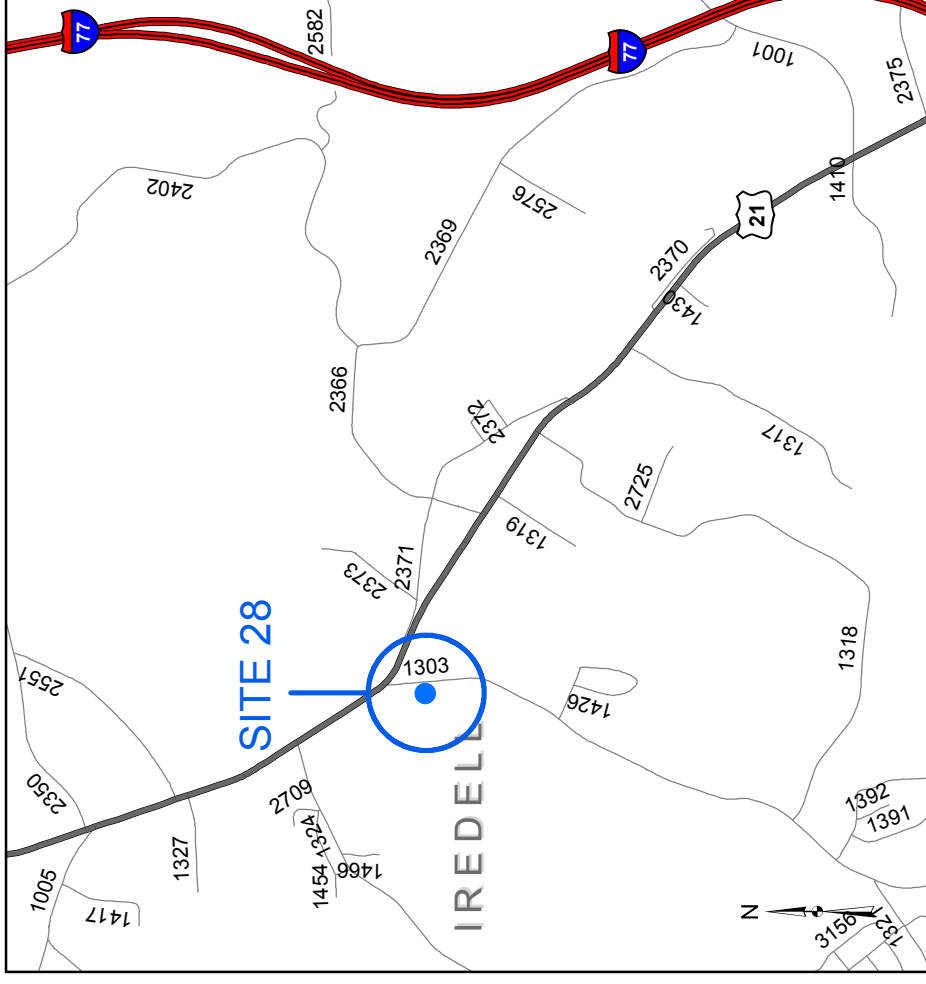
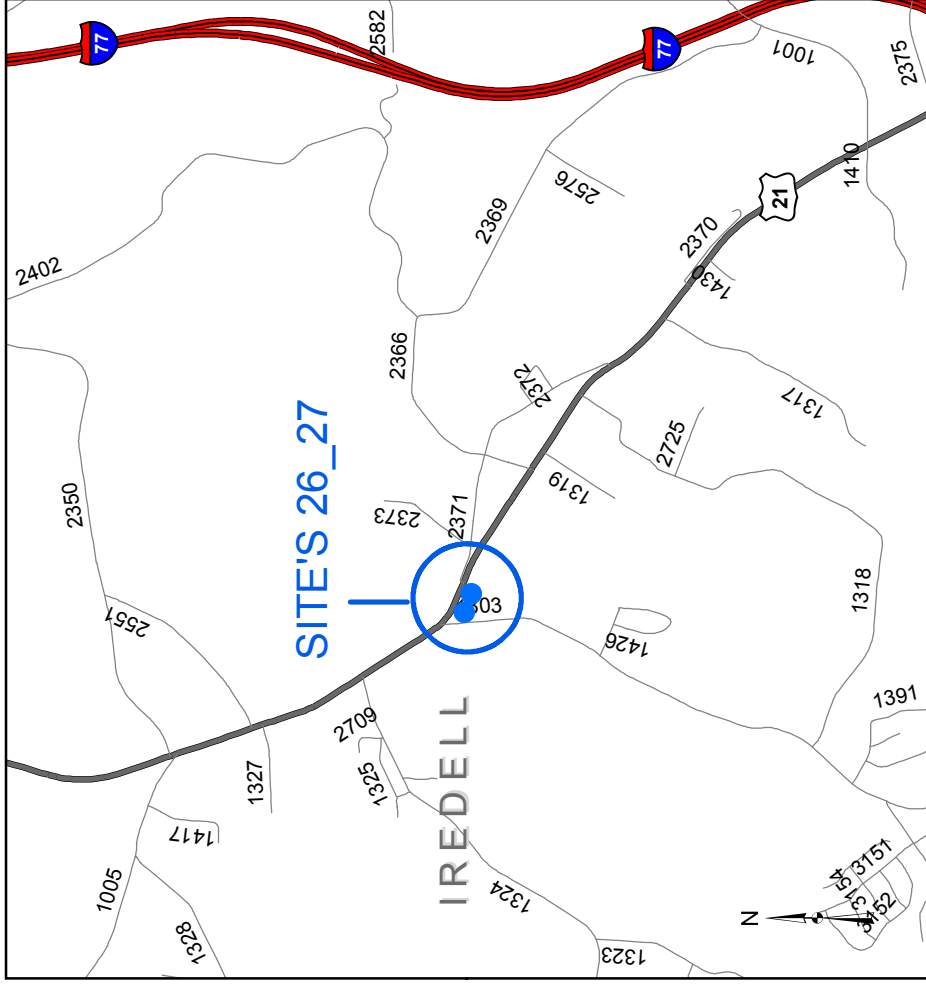

US 21 (N. MAIN STR.) @ RUMPLE STR.



SR 1303 (PERTH RD/WAGNER STR.) @ SR 1303
(160 WAGNER STR.) (380' SOUTH OF S. MAIN STR.)

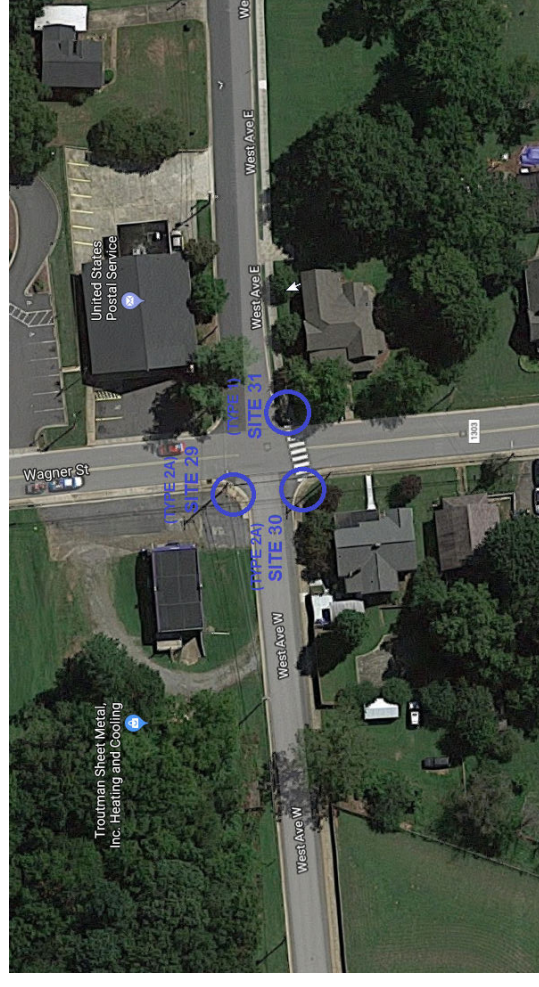

SR 1303 (PERTH RD./ WAGNER STR.) @ W. WEST AVE.



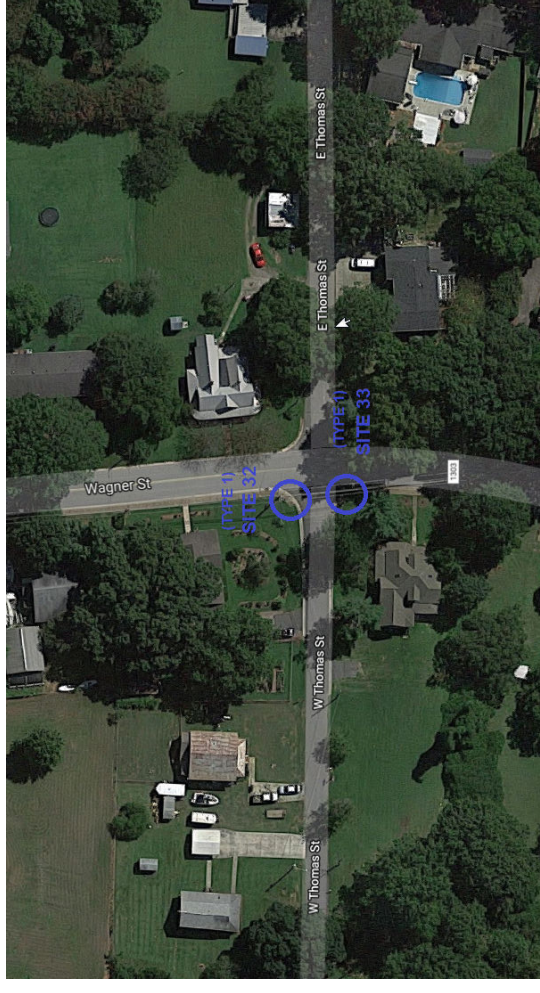
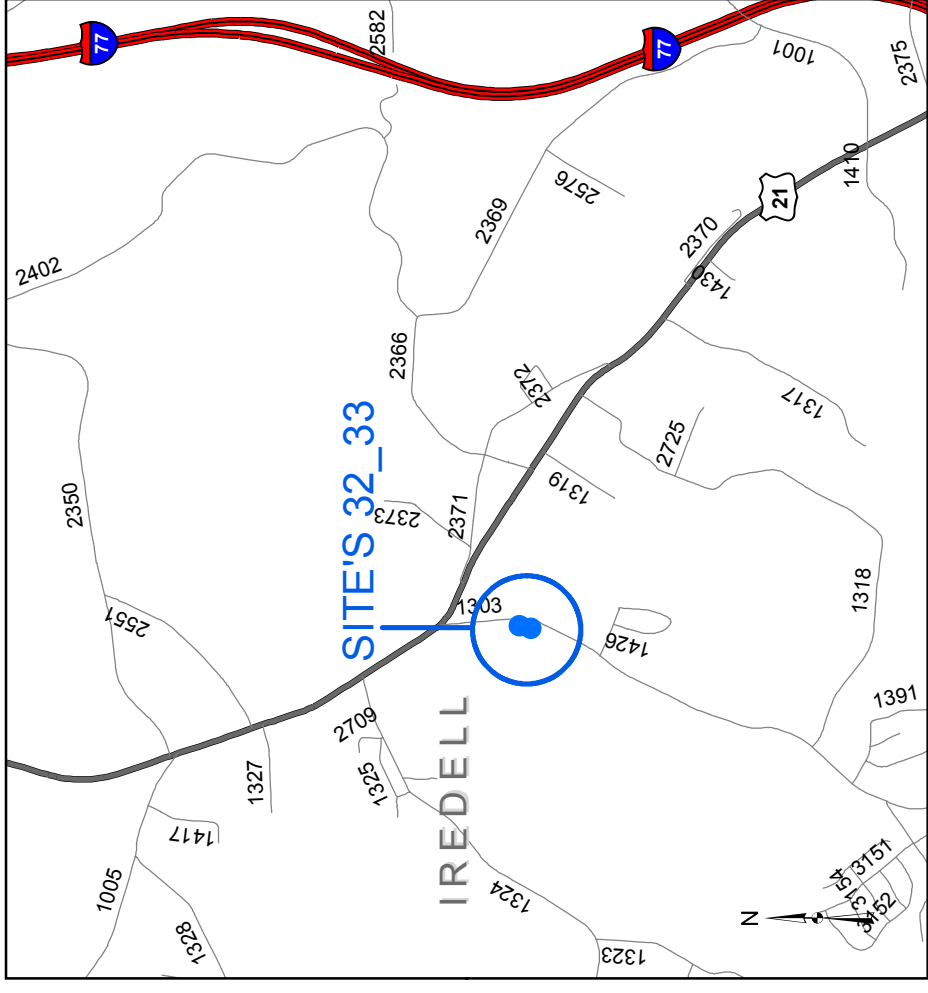

SR 1303 (PERTH RD/ WAGNER STR.) @ W. THOMAS STR.

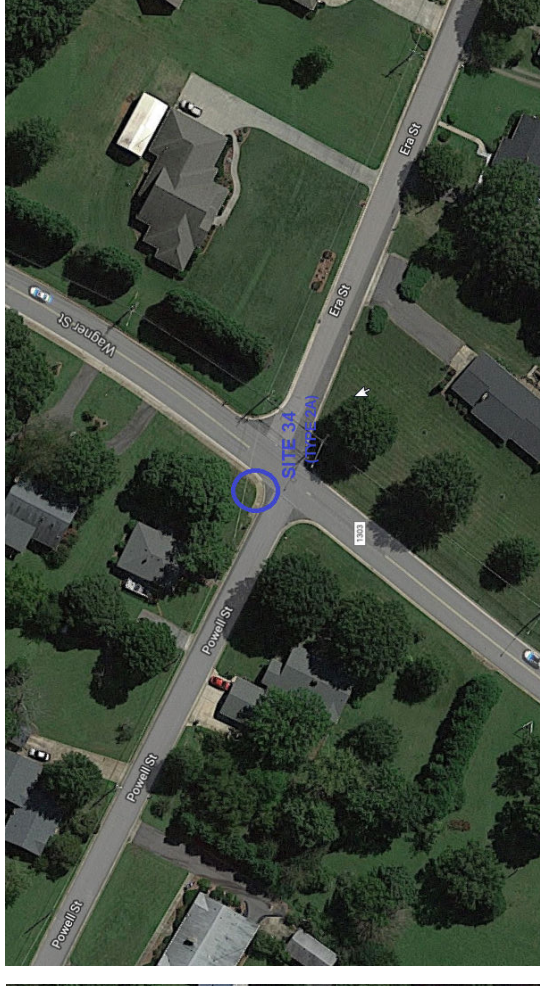
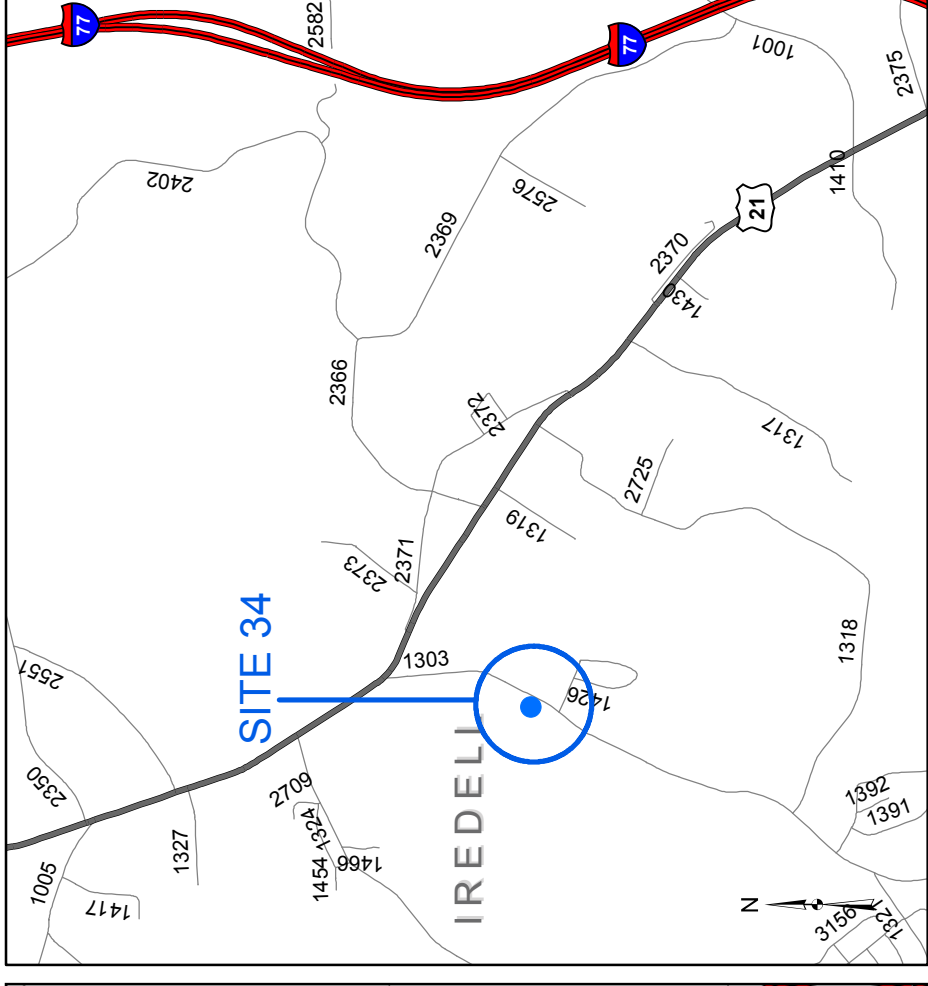

SR 1303 (PERTH RD/ WAGNER STR.) @ POWELL STR.

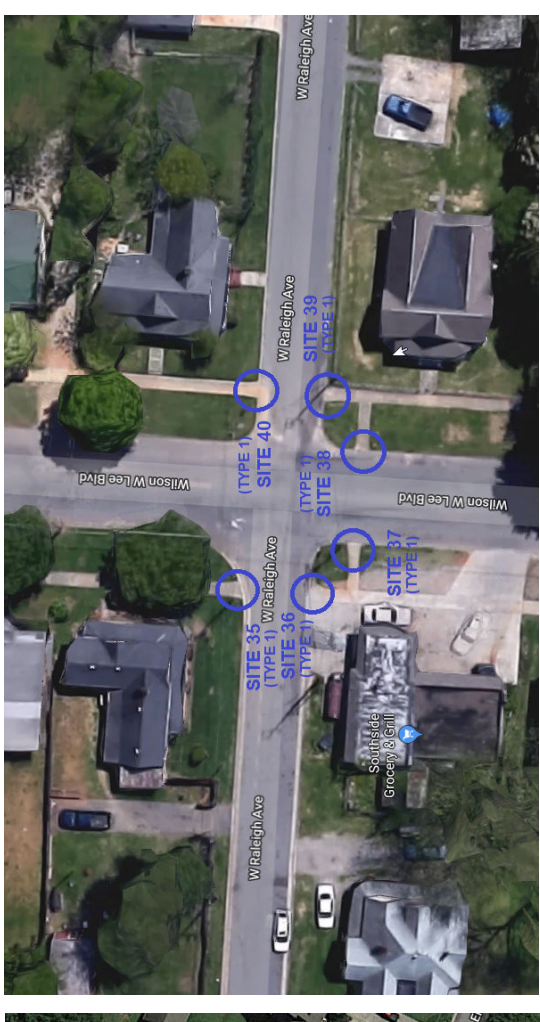
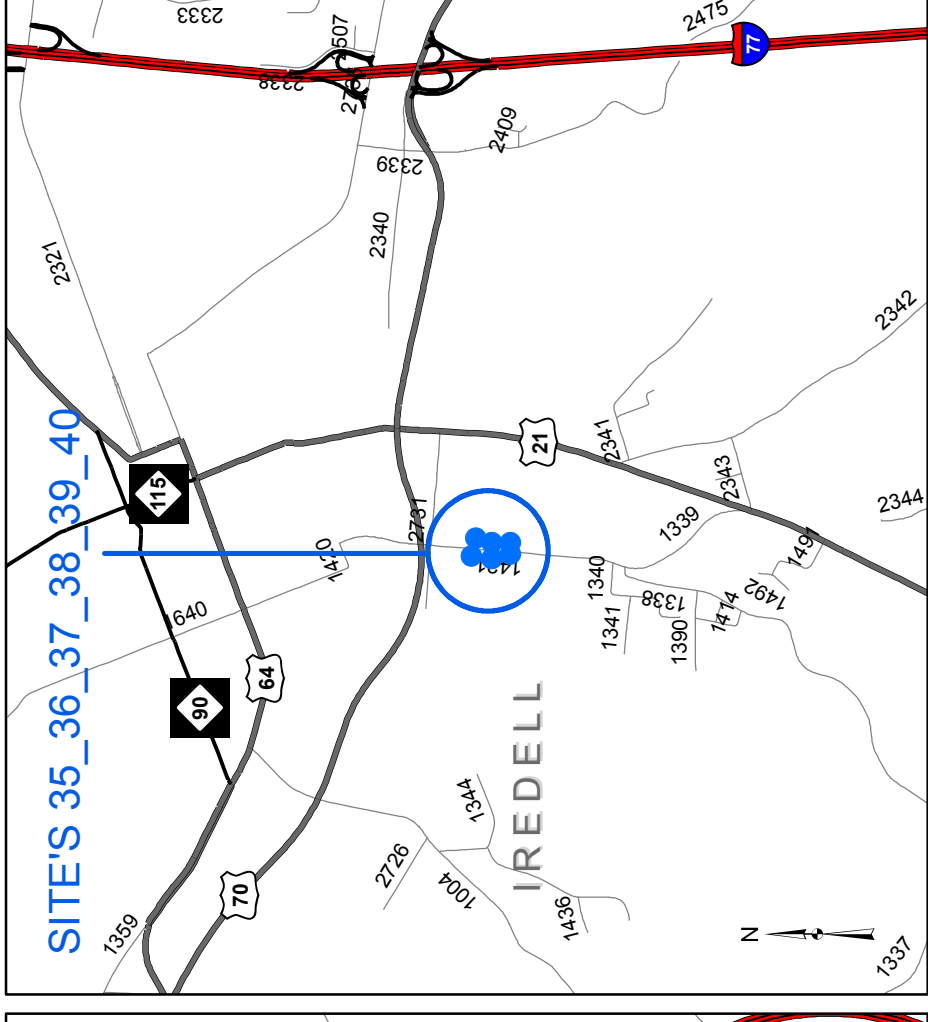

SR 1421 (WILSON LEE BLVD.) @ W. RALEIGH AVE.

IREDELL COUNTIES
TIP# R-5792AE,AC



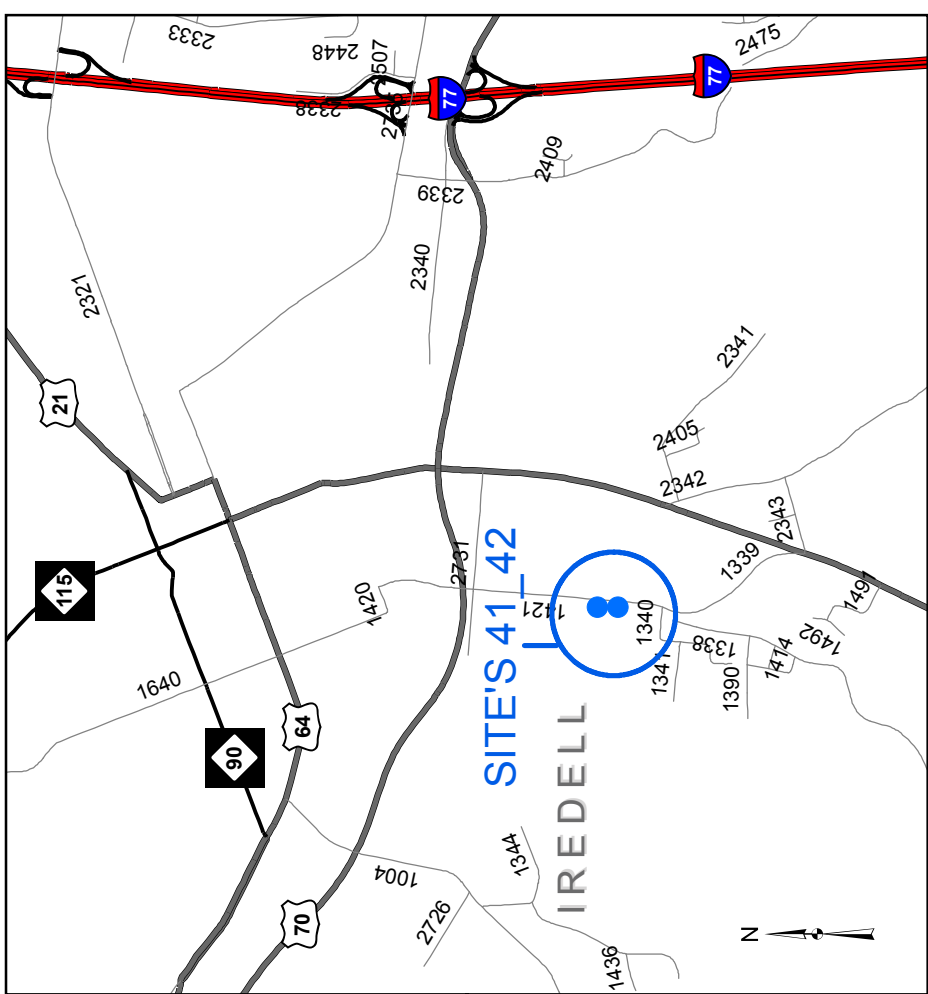
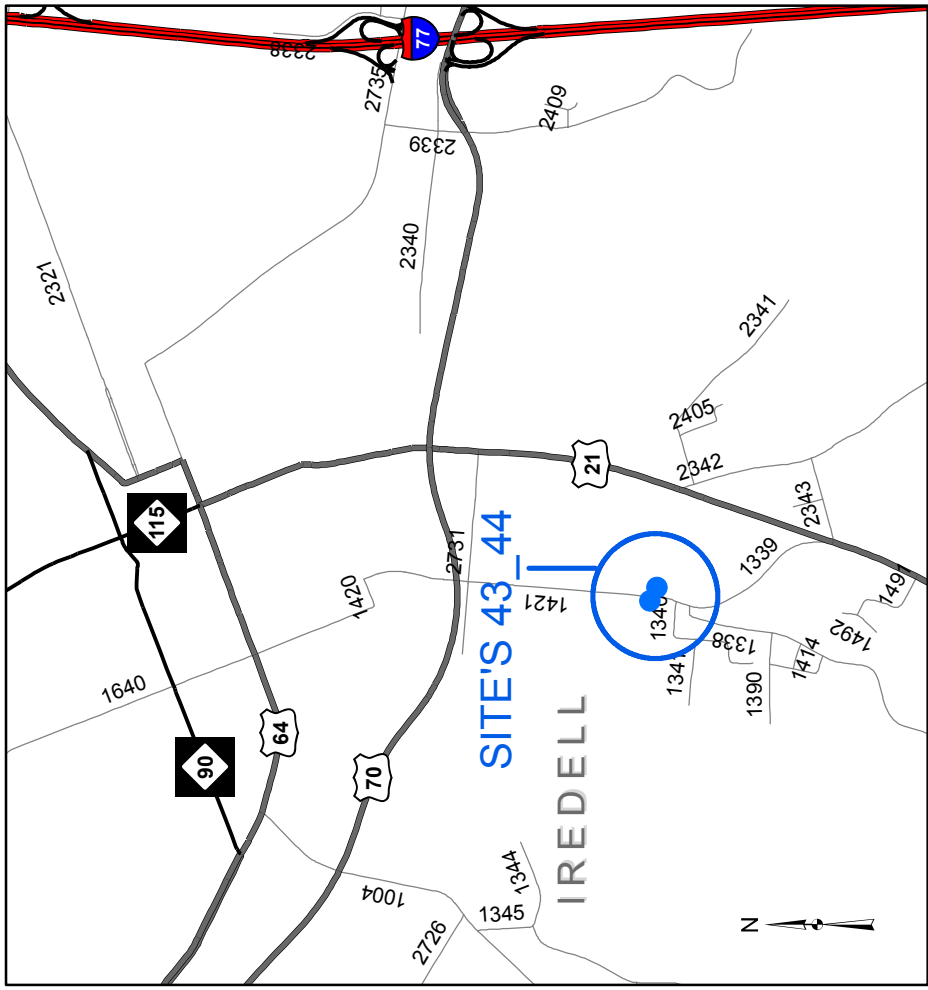
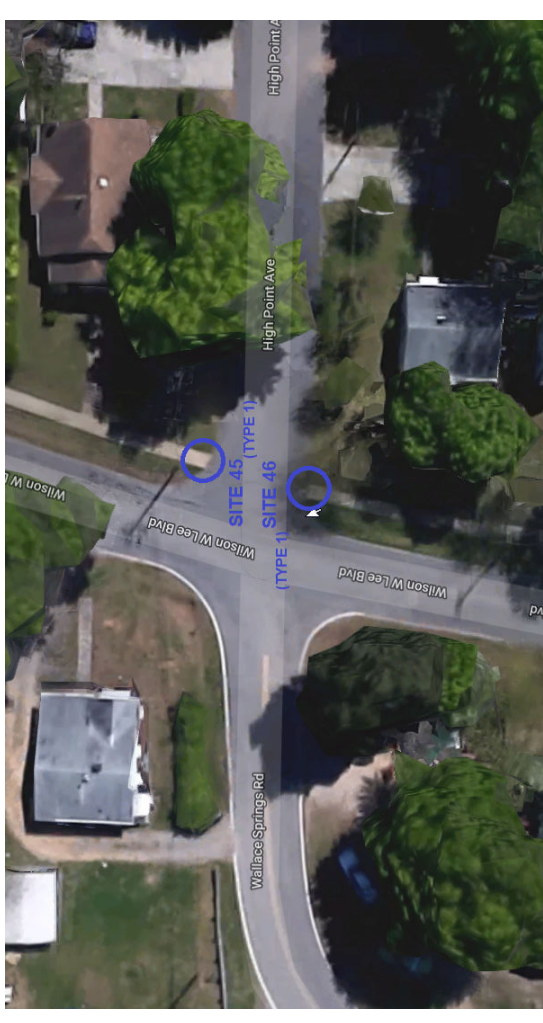
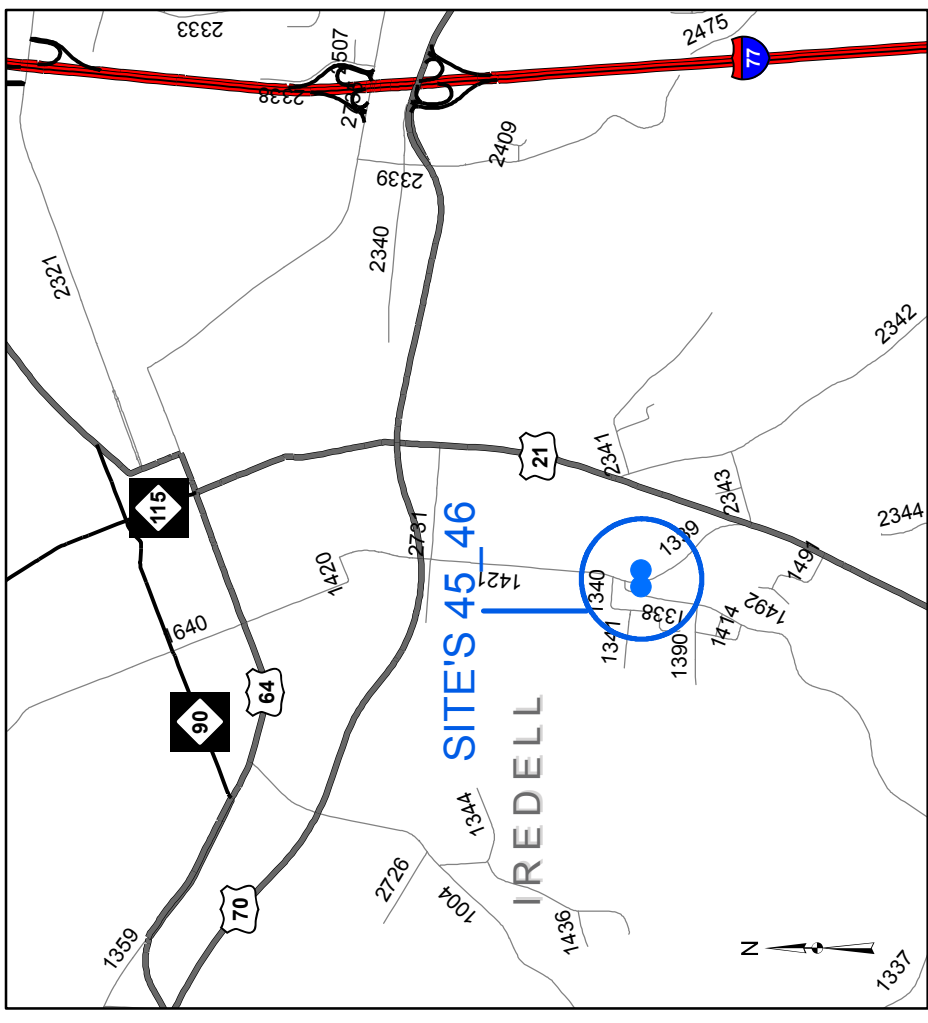

SR 1421 (WILSON LEE BLVD.) @ HIGH POINT AVE.

SR 1421 (WILSON LEE BLVD.) @ GOLDSBORO AVE.

SR 1421 (WILSON LEE BLVD.) @ WILMINGTON AVE.

SUMMARY OF QUANTITIES

SUMMARY OF QUANTITIES										Proj. # Sheet	R-5792AC, AE & AH 11	
Sheet #	Division	County	Municipality	Under 5k Population? (Y/N)	WBS No.	Major Route	Minor Route	Side Walk (SQ YD)	Retrofit Existing Concrete Curb Ramp (EA)	Remove and Replace Existing Curb Ramp (EA)	Site No.	Comments
4	12	Alexander	Town of Taylorsville	Y	44922.3.13	SR 1104 (School Drive)	223 School Drive (Alexander Central High School)		2		1_2	(2) Retro-Fit
4	12	Alexander	Town of Taylorsville	Y	44922.3.13	SR 1819 (7TH Street)	SR 1819 (Taylorsville Elementary School)(7TH Str.)			2	3_4	(2) Type 1
4	12	Alexander	Town of Taylorsville	Y	44922.3.13	SR 1819 (7TH Street)	SR 1819 (Taylorsville Elementary School)(7TH Str.)	8			5	Approx. 16' of Conc. Sidewalk
4	12	Alexander	Town of Taylorsville	Y	44922.3.13	SR 1411 (Linneys Mountain Road)	5th Avenue NE			2	6_7	(2) Type 1
5	12	Alexander	Town of Taylorsville	Y	44922.3.13	SR 1411 (Linneys Mountain Road)	SR 1412 (Black Oak Ridge Road)			4	8_9_10_11	(1) Type 1, (3) Type 2A
5	12	Alexander	Town of Taylorsville	Y	44922.3.13	SR 1411 (Linneys Mountain Road)	2nd Avenue NE			2	12_13	(2) Type 1
5	12	Iredell	Town of Harmony	Y	44922.3.12	US-21	3349 Harmony Highway (Dollar General)			2	14_15	(2) Type 1
6	12	Iredell	Town of Harmony	Y	44922.3.12	NC-901	136 W Memorial Hwy (Harmony United Methodist Church)			1	16	(1) Type 1
6	12	Iredell	Town of Harmony	Y	44922.3.12	E NC-901 (E Memorial Hwy)	Isa's Lum Street (1000' East of US 21)			1	17	(1) Type 1
6	12	Iredell	Town of Harmony	Y	44922.3.12	US-21 (N Main Street)	SR 1324 (Talley Street)			2	18_19	(2) Type 1
7	12	Iredell	Town of Troutman	Y	44922.3.12	US-21 (N Main Street)	265 N Main St. Ste D (Domino's Pizza)			2	20_21	(2) Type 1
7	12	Iredell	Town of Troutman	Y	44922.3.12	US-21 (N Main Street)	Mills Avenue			2	22_23	(2) Type 1
7	12	Iredell	Town of Troutman	Y	44922.3.12	US-21 (N Main Street)	W Church Street			2	24_25	(2) Type 1
8	12	Iredell	Town of Troutman	Y	44922.3.12	US-21 (S Main Street)	Rumple Street			2	26_27	(1) Type 1, (1) Type 2A
8	12	Iredell	Town of Troutman	Y	44922.3.12	SR 1303 (Perth Road / Wagner Street)	SR 1303 (160 Wagner Street) (380' South of S Main Street)			1	28	(1) Type 1-Beginning of Sidewalk
8	12	Iredell	Town of Troutman	Y	44922.3.12	SR 1303 (Perth Road / Wagner Street)	West Avenue West			3	29_30_31	(2) Type 2A, (1) Type 1
9	12	Iredell	Town of Troutman	Y	44922.3.12	SR 1303 (Perth Road / Wagner Street)	West Thomas Street			2	32_33	(2) Type 1
9	12	Iredell	Town of Troutman	Y	44922.3.12	SR 1303 (Perth Road / Wagner Street)	Powell Street			1	34	(1) Type 2A
9	12	Iredell	City of Statesville	N	44922.3.8	SR 1421 (Wilson Lee Boulevard)	W Raleigh Avenue			6	35_36_37_38_39_40	(6) Type 1
10	12	Iredell	City of Statesville	N	44922.3.8	SR 1421 (Wilson Lee Boulevard)	Wilmington Avenue			2	41_42	(2) Type 1
10	12	Iredell	City of Statesville	N	44922.3.8	SR 1421 (Wilson Lee Boulevard)	Goldsboro Avenue			2	43_44	(2) Type 1
10	12	Iredell	City of Statesville	N	44922.3.8	SR 1421 (Wilson Lee Boulevard)	High Point Avenue			2	45_46	(2) Type 1
							TOTAL	8	2	43	46 SITES	

STATE OF NORTH CAROLINA
DIVISION OF HIGHWAYS

TRANSPORTATION MANAGEMENT PLAN
ALEXANDER & IREDELL COUNTIES

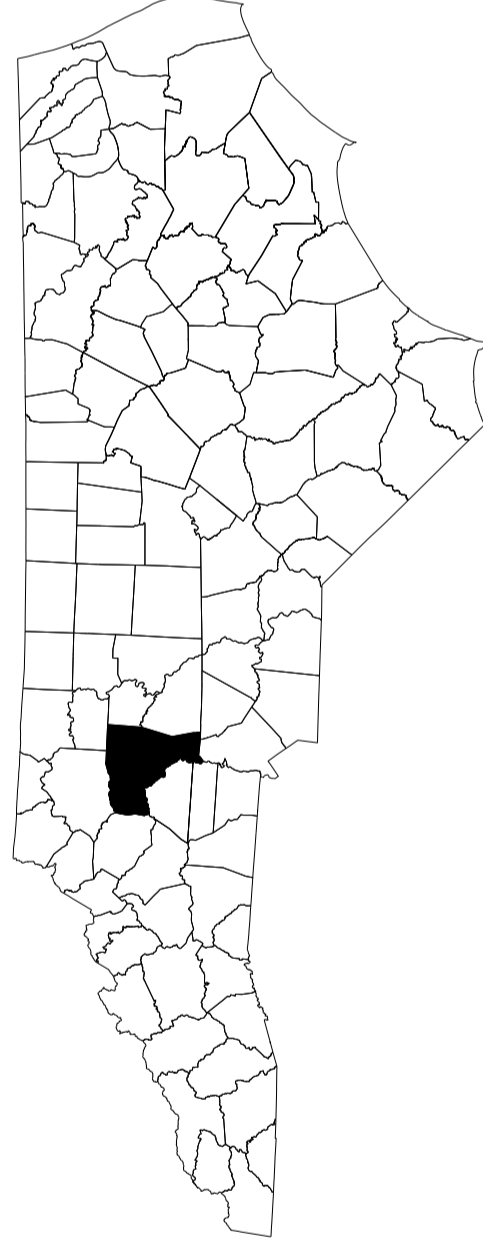

ROADWAY STANDARD DRAWINGS

THE FOLLOWING ROADWAY STANDARDS AS SHOWN IN "ROADWAY STANDARD DRAWINGS" - PROJECT SERVICES UNIT - N.C. DEPARTMENT OF TRANSPORTATION - RALEIGH, N.C., DATED JANUARY 2018 ARE APPLICABLE TO THIS PROJECT AND BY REFERENCE HEREBY ARE CONSIDERED A PART OF THESE PLANS:

STD. NO.	TITLE
1101.01	WORK ZONE ADVANCE WARNING SIGNS
1101.02	TEMPORARY LANE CLOSURES
1101.04	TEMPORARY SHOULDER CLOSURES
1101.11	TRAFFIC CONTROL DESIGN TABLES
1110.02	PORTABLE WORK ZONE SIGNS
1115.01	FLASHING ARROW BOARDS
1130.01	DRUM
1135.01	CONES
1150.01	FLAGGING DEVICES
1180.01	SKINNY-DRUM

LEGEND

TRAFFIC CONTROL DEVICES

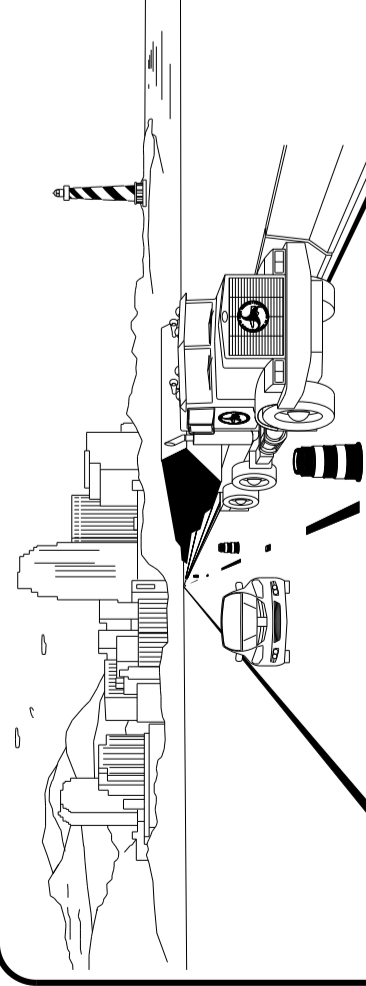
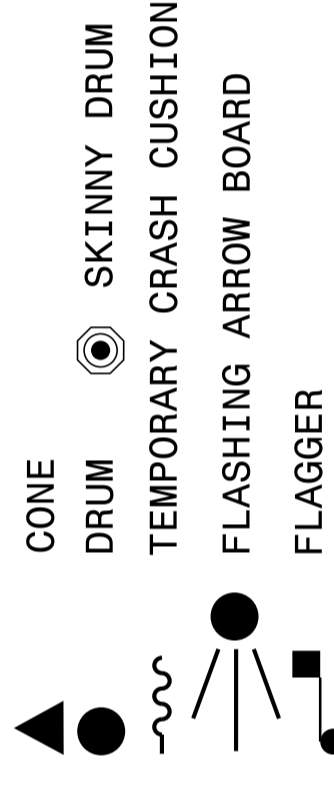

WORK ZONE SAFETY & MOBILITY
"From the MOUNTAINS to the COAST"



INDEX OF SHEETS

SHEET NO.	TITLE
TMP-1	TITLE SHEET, LIST OF APPLICABLE ROADWAY STANDARD DRAWINGS, LEGEND AND INDEX OF SHEETS
TMP-1B	TRANSPORTATION OPERATIONS PLAN: (MANAGEMENT STRATEGIES, GENERAL NOTES, AND LOCAL NOTES)

GENERAL NOTES / LOCAL NOTES

CHANGES MAY BE REQUIRED WHEN PHYSICAL DIMENSIONS IN THE DETAIL DRAWINGS, STANDARD DETAILS, AND ROADWAY DETAILS ARE NOT ATTAINABLE TO MEET FIELD CONDITIONS OR RESULT IN DUPLICATE OR UNDESIRABLE OVERLAPPING OF DEVICES. MODIFICATION MAY INCLUDE: MOVING, SUPPLEMENTING, COVERING, OR REMOVAL OF DEVICES AS DIRECTED BY THE ENGINEER.

THE FOLLOWING GENERAL NOTES APPLY AT ALL TIMES FOR THE DURATION OF THE CONSTRUCTION PROJECT EXCEPT WHEN OTHERWISE NOTED IN THE PLAN OR DIRECTED BY THE ENGINEER.

TIME RESTRICTIONS

A) DO NOT CLOSE OR NARROW TRAVEL LANES AS FOLLOWS:

ROAD NAME	DAY AND TIME RESTRICTIONS
I. ANY US OR NC ROUTE	MONDAY - FRIDAY: 7:00 A.M. - 9:00 A.M. 4:00 P.M. - 6:00 P.M.

B) DO NOT CLOSE OR NARROW TRAVEL LANES DURING HOLIDAYS AND SPECIAL EVENTS AS FOLLOWS:

ROAD NAME

ANY ROAD

HOLIDAY

- FOR ANY UNEXPECTED OCCURRENCE THAT CREATES UNUSUALLY HIGH TRAFFIC VOLUMES, AS DIRECTED BY THE ENGINEER.
- FOR NEW YEAR'S, BETWEEN THE HOURS OF 9:00 A.M. DECEMBER 31st TO 4:00 P.M. JANUARY 2ND. IF NEW YEAR'S DAY IS ON A FRIDAY, SATURDAY, SUNDAY, OR MONDAY THEN UNTIL 9:00 A.M. THE FOLLOWING TUESDAY.
- FOR EASTER, BETWEEN THE HOURS OF 9:00 A.M. THURSDAY AND 4:00 P.M. MONDAY.
- FOR MEMORIAL DAY, BETWEEN THE HOURS OF 9:00 A.M. FRIDAY TO 4:00 P.M. TUESDAY.
- FOR INDEPENDENCE DAY, BETWEEN THE HOURS OF 9:00 A.M. THE DAY BEFORE INDEPENDENCE DAY AND 4:00 P.M. THE DAY AFTER INDEPENDENCE DAY.

IF INDEPENDENCE DAY IS ON A FRIDAY, SATURDAY, SUNDAY OR MONDAY THEN BETWEEN THE HOURS OF 9:00 A.M. THE THURSDAY BEFORE INDEPENDENCE DAY AND 4:00 P.M. THE TUESDAY AFTER INDEPENDENCE DAY.
- FOR LABOR DAY, BETWEEN THE HOURS OF 9:00 A.M. FRIDAY AND 4:00 P.M. TUESDAY.
- FOR THANKSGIVING DAY, BETWEEN THE HOURS OF 9:00 A.M. TUESDAY TO 4:00 P.M. MONDAY.
- FOR CHRISTMAS, BETWEEN THE HOURS OF 9:00 A.M. THE FRIDAY BEFORE THE WEEK OF CHRISTMAS DAY AND 4:00 P.M. THE FOLLOWING TUESDAY AFTER THE WEEK OF CHRISTMAS.

LANE AND SHOULDER CLOSURE REQUIREMENTS

- B) REMOVE LANE CLOSURE DEVICES FROM THE LANE WHEN WORK IS NOT BEING PERFORMED BEHIND THE LANE CLOSURE OR WHEN A LANE CLOSURE IS NO LONGER NEEDED OR AS DIRECTED BY THE ENGINEER.
- C) WHEN PERSONNEL AND/OR EQUIPMENT ARE WORKING WITHIN 15 FT. OF AN OPEN TRAVEL LANE, CLOSE THE NEAREST OPEN SHOULDER USING ROADWAY STANDARD DRAWING NO. 1101.04 UNLESS THE WORK AREA IS PROTECTED BY BARRIER OR GUARDRAIL OR A LANE CLOSURE IS INSTALLED.
- D) WHEN PERSONNEL AND/OR EQUIPMENT ARE WORKING ON THE SHOULDER ADJACENT TO AN UNDIVIDED FACILITY AND WITHIN 5 FT. OF AN OPEN TRAVEL LANE, CLOSE THE NEAREST OPEN TRAVEL LANE USING ROADWAY STANDARD DRAWING NO. 1101.02 UNLESS THE WORK AREA IS PROTECTED BY BARRIER OR GUARDRAIL.
- WHEN PERSONNEL AND/OR EQUIPMENT ARE WORKING ON THE SHOULDER ADJACENT TO A DIVIDED FACILITY AND WITHIN 10 FT. OF AN OPEN TRAVEL LANE, CLOSE THE NEAREST OPEN TRAVEL LANE USING ROADWAY STANDARD DRAWING NO. 1101.02 UNLESS THE WORK AREA IS PROTECTED BY BARRIER OR GUARDRAIL.
- E) WHEN PERSONNEL AND/OR EQUIPMENT ARE WORKING WITHIN A LANE OF TRAVEL OF AN UNDIVIDED OR DIVIDED FACILITY, CLOSE THE LANE ACCORDING TO THE TRAFFIC CONTROL PLANS, ROADWAY STANDARD DRAWINGS, OR AS DIRECTED BY THE ENGINEER. CONDUCT THE WORK SO THAT ALL PERSONNEL AND/OR EQUIPMENT REMAIN WITHIN THE CLOSED TRAVEL LANE.
- F) DO NOT WORK SIMULTANEOUSLY WITHIN 15 FT. ON BOTH SIDES OF AN OPEN TRAVELWAY, RAMP, OR LOOP WITHIN THE SAME LOCATION UNLESS PROTECTED WITH GUARDRAIL OR BARRIER.

PAVEMENT EDGE DROP OFF REQUIREMENTS

- G) BACKFILL AT A 6:1 SLOPE UP TO THE EDGE AND ELEVATION OF EXISTING PAVEMENT IN AREAS ADJACENT TO AN OPENED TRAVEL LANE THAT HAS AN EDGE OF PAVEMENT DROP-OFF AS FOLLOWS:
BACKFILL DROP-OFFS THAT EXCEED 2 INCHES ON ROADWAYS WITH POSTED SPEED LIMITS OF 45 MPH OR GREATER.
BACKFILL DROP-OFFS THAT EXCEED 3 INCHES ON ROADWAYS WITH POSTED SPEED LIMITS LESS THAN 45 MPH.
BACKFILL WITH SUITABLE COMPACTED MATERIAL, AS APPROVED BY THE ENGINEER, AT NO EXPENSE TO THE DEPARTMENT.
- H) INSTALL ADVANCE WORK ZONE WARNING SIGNS WHEN WORK IS WITHIN 40 FT. FROM THE EDGE OF TRAVEL LANE AND NO MORE THAN THREE (3) DAYS PRIOR TO THE BEGINNING OF CONSTRUCTION.



TRANSPORTATION
OPERATIONS
PLAN